

**WOOD COUNTY
HIGHWAY INFRASTRUCTURE & RECREATION COMMITTEE
AGENDA**

DATE: September 5, 2019
TIME: 8:00 a.m.
PLACE: Wood County ATV Intensive Use Area Shelter,
4415 State Hwy. 54,
Port Edwards, WI 54469

1. Call meeting to order.
2. Declaration of Quorum.
3. Public comments.
4. Correspondence
5. **CONSENT AGENDA**
 - a. Approve minutes from previous committee meetings
 - b. Department Staff Reports
 - c. Department Vouchers
 - d. Department Revenue Reports
6. Review items, if any, pulled from consent agenda
7. ATV Update: 2nd Ribbon Cutting Ceremony for the new ATV Route/Trail System will be held at Dexter County Park on September 18, 2019 at 5pm.
8. **HIGHWAY**
 - a. 2020 Budget
 - b. Sale of Low Use Highway Properties
 - c. Access Policy
 - d. July Storm Update
 - e. Senate Bill 244 and Assembly Bill 262 – Vehicle Owner Liability Work Zone
9. **PARKS AND FORESTRY**
 - a. Letter from Chris McDaniel, Town of Richfield Supervisor
 - b. 2019 Renewable and Sustainable Grant Application for Solar panels at Nepco Lake County Park
 - c. Fleet Vehicle Replacement quotes
 - d. Parks, Forestry, and Highway tour route
 - e. Parks Revenue Report
 - f. Forestry Revenue Report
 - g. Storm Damage/Salvage Update
10. Future Agenda Items
11. Set next regular meeting date: **October 3, 2019** Wood County Highway Department,
555 17th Ave North, Wisconsin Rapids, WI 54495
*Special Meeting: Parks, Forestry & Highway Tour. **September 19, 2019.** Time TBD.
12. Adjournment.

**MINUTES OF THE
HIGHWAY, INFRASTRUCTURE & RECREATION COMMITTEE**

DAY & DATE: Thursday, August 8, 2019
PLACE: Wood County Highway Department, 555 17th Ave North, Wisconsin Rapids, WI 54495
MEETING TIME: 8:00 A.M.
ADJOURNMENT TIME: 10:00 A.M.
MEMBERS PRESENT: Chairman Adam Fischer, Supervisor William Winch, Supervisor Lance Pliml, Supervisor Dennis Polach, Supervisor Marion Hokamp
OTHERS PRESENT: Bill Clendenning, Wood County Board; Commissioner Roland Hawk, Parks and Forestry Director Chad Schooley; Parks & Forestry Office Supervisor, Sandra Green; Forest Administrator Fritz Schubert; DNR Forester, Gavin Hutchinson; Pete Winistorfer, Town of Rock; Jodi Lubeck assisting Supervisor Winch

1. Call meeting to order. Meeting called to order at 8:00 am.
2. Declaration of Quorum. A quorum declared.
3. Public comments. Pete Winestorf, Chairman for Town of Rock. He stated he is communicating as a Town of Rock resident, unless directed differently by the board.
4. Correspondence.
 - Letter sent to County Board Supervisors inquiring about townships receiving additional revenue share of County Forest timber sales, and revenue from parks to assist in funding adjacent town roads. This will be on the September agenda to discuss.
 - R. Hawk said that he attended a recent meeting regarding resolution to oppose a couple of bills for heavier trucks. They are looking at scheduling a special HIRC meeting prior to next county board to sign these resolutions.
 - Bill Clendenning, Discussion at recent RC&D meeting included resolution from Burnett County regarding the State Forest Administrator's Grant. Supervisor Clendenning has shared this information with C. Schooley and F. Schubert.
 - Highway AC heater failed recently. They found a company that would make them another one and have the money in the machinery fund to purchase this. They will be ordering this tomorrow and installing it in a couple of weeks.
 - The Pittsville area ATV Route/Trail Ribbon Cutting ceremony is scheduled for September 18, 2019 to begin sometime in later afternoon, approximately 4:30pm. More details to come.
5. **CONSENT AGENDA.** Per Supervisor Winch, pull pages 11, 12, 13, 14, 16, 17, 18, 19, 20. Per Chairman Fischer, page 10. **Motion by L. Pliml and second by M. Hokamp. Motion carried.**
 - a. Approve minutes from previous committee meetings
 - b. Department Staff Reports
 - c. Department Vouchers
 - d. Department Revenue Reports
6. Review items, if any, pulled from consent agenda
 - Chairman Fischer began with page 10. C. Schooley presented Special Use Permit to allow outdoor equipment rental at our parks this year, from the company Northward Paddle and Paddle. He would like to do a pop-up event this fall at some of the park locations for a daylong rental at the boat landings of kayaks. C. Schooley will have Corp. Coun. review any agreement for this event. **Motion to approve providing rental equipment within the parks such as Kayaks, Canoes, Paddleboards, etc. by L. Pliml and second by B. Winch. Motion carried.**

- B. Winch believes it is wrong the Parks is fundraising for Powers Bluff when they have not given a bottom dollar for each phase yet. B. Winch asked questions regarding the other pages pulled from the Consent Agenda. B. Winch continued with questions on the other items pulled from the Consent Agenda.

Motion by L. Pliml and second by D. Polach to approve the Consent Agenda. Motion carried.

7. ATV Policy for Shared Highways (Highway). R. Hawk discussed regarding the Township of Grand Rapids. There should be a policy that we would not open any county roads or force any Wood County townships to open their roads to ATV traffic. A. Fischer states we do need some consistency from a policy standpoint. L. Pliml agrees but take a second look at this. In Grand Rapids, you are allowed to cross from one side to the other, allowed to use the most direct route, not necessarily perpendicular. This is something that will evolve and we should take a longer look at this before we create a policy.
Motion to approve L. Pliml and second by B. Winch to approve moving forward to create a policy to not allow the county to order a municipality to become an ATV route.

8. HIGHWAY

- a. Employee Recognition – 40 Year Anniversary. Steve Breu, 40 years to one employer deserves recognition. He started in 1979.
- b. Employee Policy – Reporting to Work Site. **Motion to approve the policy as presented, L. Pliml and second by M. Hokamp. Motion carried.**
- c. Sale of Low-Use Highway Properties. R. Hawk would like a few things verified before he moves forward with a resolution. Will put the parcels up for bid on state surplus auction site. It is more advantageous to go through a Phase 2 process with this 40-acre parcel. **Motion to spend up to \$10,000 for this process by L. Pliml, second by D. Polach. Motion carried.**
R. Hawk presented a parcel that is five acres within the existing quarry parcel. He stated they would not want the sale of this parcel to restrict the Department from being able to continue mining on the property if the five acres is sold. L. Pliml recommended a deed restriction that states whomever owns this property could not build a dwelling on this parcel, which may impede mining operations. P. Kastenholz would have to draft the language for the resolution to be sure all is in order before moving forward. R. Hawk states there are two ways to sell this property. Direction is have a conversation with P. Kastenholz and be sure Wood County is doing everything correctly and then bring this back to the committee for approval. Tabled for a later date.
- d. Updated Access Policy. Chairman Fischer requests that this be brought back to the committee next month for consideration.
- e. Sign Crew Staffing. Additional sign crew member position. This would be funded 80 percent by the State Maintenance funds. Salary cost for this position would be approximately \$45K. **Motion by D. Polach and second by M. Hokamp. Motion carried.**
- f. Overweight Vehicle Forfeiture Violations

9. PARKS AND FORESTRY

- a. Fleet vehicle replacement request. P&F has a 2005 F150 they would like to replace with the Highway Department's 2006 GMC Canyon, which they were going to sell on the Wisconsin Surplus Auction website. A fair price that was agreed upon is \$3K. The second vehicle P&F would like to replace is a 2011 Chevy Equinox. Although this vehicle has low miles it has had engine issues for the past couple years. The Highway Dpt. Mechanic has recommended replacing this vehicle sooner than later. C. Schooley would like to use monies from their non-lapsing equipment auction fund to purchase both of these vehicles. **Motion to replace both**

vehicles and with a process that is most advantageous to Wood County by M. Hokamp and second by B. Winch. Motion carried.

- b. Low use park property. C. Schooley handed out a map of locations within South Wood County Park that have been identified as low use areas. Chad stated that these areas may not be currently being used, but there is definitely future potential use due to the high amount of visitors that enjoy this park. Consent of committee was to table this item indefinitely.
- c. MSA Powers Bluff Update. C. Schooley handed out maps and drawings of these properties to show the updates and changes to the Master Plan. They will be providing an estimate for this project in the near future. They are targeting the September or October HIRC meeting for a presentation by MSA, along with a full estimate.
- d. Parks Revenue Report. Discussed.
- e. Forestry Revenue Report. Discussed. There was some scattered storm damage in the area. More significant damage in specific areas and will be setting up direct sales for cleanup.
Motion to approve both reports by D. Polach and second by M. Hokamp. Motion carried.
- f. Contract Extension: #767 Wiitala & Vozka Logging. Requesting that the committee grant a one year extension on this contract that expires 6/1/2020. Contractor is requesting this due to recent storms and heavy storm damage to areas in northern Wisconsin and resulting need to concentrate efforts there. Pros and cons of granting this early extension were discussed. F. Schubert's recommendation is to do a 6-month extension. **Motion to approve a 6-month extension by B. Winch and second by M. Hokamp. All yes, 1 no by A. Fischer for the reasons that it's too early to even consider an extension and would make more sense to do this in late winter or early spring. Motion carried.**
- g. Set date for Parks, Forestry & Highway Tour. Tentatively set for September 19, 2019. Meet at Highway Dept. at 8:00 am. C. Schooley, F. Schubert and R. Hawk will create an agenda for this day. Roland would like to include the asphalt plant to the tour.

10. Future Agenda Items.

11. **Special Budget HIRC Meeting** scheduled for **August 22, 2019 at 8:00 am** at the Wood County Highway Department, 555 17th Ave North, Wisconsin Rapids, WI 54495.
Next regular meeting date: **September 5, 2019 at 8:00 am** at the ATV Intensive Use Area Shelter, 4415 State Hwy. 54, Port Edwards, WI 54469

12. Fischer declared the meeting adjourned at 10:00 am.

Signed by, Secretary Marion Hokamp

Marion Hokamp

Minutes taken by Sandra Green, Parks & Forestry Office Supervisor



Wood County

WISCONSIN

OFFICE OF
HIGHWAY COMMISSION

Roland Hawk
COMMISSIONER

September 5, 2019

To: Highway, Infrastructure & Recreation Committee

From: Roland Hawk, Highway Commissioner

Subject: Commissioner Report for September 5, 2019 HIRC meeting

Department Activities

Personnel

A mechanic resigned August 16, began advertising for a replacement. Interviews will take place in September.

Highway Projects

CTH U (STH 54 – S Biron Dr.) Construction YR 2020. Acquisition of R/W complete.

CTH U (Bridgewater/Classic Development) Commissioner working on Jurisdictional Transfer of segment old highway and discontinuance of a segment.

CTH H West County Line to Lincoln Ave, contracted with WDOT, project is complete and open to traffic.

CTH N Bridge, near intersection of CTH T, Town of Richfield. Bridge is complete and open to traffic.

CTH V from Cary-Rock Road to US 10 is open to traffic, have to complete shoulder work.

CTH S from CTH F to CTH C, Town of Sigel, project is complete and open to traffic. Some additional ditch cleaning will be performed in the next few months.

CTH D from Elm Lake Road to STH 73 scheduled to be paved and open to traffic by September 13.

Highway Maintenance

Significant storm damage on Friday July 19 and Saturday July 20. Estimated cleanup cost is between \$80K - \$90K. Due to the extent of debris to remove from the R/W and the late construction start from a cold-wet spring, highway department has one small crew working on debris cleanup until construction projects are completed.

ATV Plan

CTH Q was signed and open to ATV/UTV traffic in early August. A resident in the Town of Saratoga has requested the Commissioner to open a portion of CTH Z from Heminger Court to Hillcrest Ave. (approximately ¼ mile) (*Ongoing*)

Frac Sand Development

Agreement and invoice for improvements to CTH V was sent to Carbo Ceramics for signatures July 25.

Unused/Low-Use County Highway Property

Commissioner has contracted with REI Engineering to conduct a limited Phase II investigation on one of the parcels in the Town of Rock know to be an inactive solid waste landfill.

Two other parcels are being prepared for listing on Wisconsin Surplus Auction site.

The commissioner is working with Corporation Council on sale procedures for the portion that is being requested for purchase from a resident adjacent to the quarry site in the town of Carry.

Wisconsin County Highway Association

Commissioner testified in favor of AB 262 on Thursday August 22. *Agenda Item*

NC Region Legislative Breakfast is scheduled for October 18, 2019 in Stevens Point. HIRC is welcome.

Highway Access Control Policy

Commissioner shared draft Highway Access Control Policy with HIRC in August. This will replace and enhance the driveway policy and permit. *Agenda Item..*

On Line Permitting

Highway Department is working on the development of the On-Line permitting process. This was approved at the February 2019 HIRC. Expect to have the system in operation by January 1, 2020. Permits to be available are, utility, access/driveway, overweight/over length/over height, seasonal weight restriction, and special events such parades.

Accounting Supervisor Report

By John Peckham, Wood County Highway Department Accounting Supervisor

HIRC Meeting

Revenues

Revenues are as anticipated. We received the Carbo payment of \$85,000. We have been working on several Road Aid and Bridge Aid projects so the revenue will be booked as those projects get completed. Asphalt revenues continue to come in as we run the plant full-time. Revenues from the State are on target.

Expenses

Expenses are as anticipated. As required by the Uniform Cost Accounting System, I have begun using cost allocation accounts for several funds, resulting in "negative expense figures". The cost allocation accounts replace the revenue accounts for funds such as Fuel Handling and Machinery Operations.

Other

I have completed an initial draft of the budget. There are a few issues with the new budget software so the draft is not available for the packet. For the most part, I left the budget figures for supplies and materials the same as last year. The big changes will be in Personal Services, which includes wages, health insurance, FICA, etc.

If all goes well, I plan to have a draft available some time during the week of the HIRC meeting and will get it out to the members for their review before the meeting on Sept. 5th. I am happy with the new software and ecstatic that we will go from a 165 page budget document to something around 25 pages. I think the members will also enjoy the easy readability of the new reports.

Committee Report

County of Wood

Report of claims for: Highway Department

For the period of: July, 2019

For the range of vouchers: 16191686 - 16191923

Voucher	Vendor Name	Nature of Claim	Doc Date	Amount	Paid
16191686	ADVANCE JANITORIAL SERVICE & SUPPLY	Carpet/Floor/Cleaning Service	07/25/2019	\$569.05	P
16191687	AMAZON CAPITAL SERVICES	Surge Protector	07/28/2019	\$16.95	P
16191688	AT&T-ATLANTA	Telephone - Marshfield	07/13/2019	\$44.53	P
16191689	AT&T-ATLANTA	Telephone - Marshfield	07/21/2019	\$44.53	P
16191690	BROCK WHITE COMPANY	Cones, Wedges	07/12/2019	\$204.74	P
16191691	HENRY G MEIGS LLC	PG 58-28 Oil/DC200 Additive	07/17/2019	\$141,596.95	P
16191692	HENRY G MEIGS LLC	Anova Rejuvenator	07/26/2019	\$61,348.56	P
16191693	HENRY G MEIGS LLC	PG 58-28 Oil/DC200 Additive	07/17/2019	\$38,511.30	P
16191694	KOLO TRUCKING AND EXCAVATING INC	Hot Mix Sand	07/23/2019	\$19,403.82	P
16191695	STEVE SCHNEIDER TRUCKING LLC	Sand	07/19/2019	\$396.00	P
16191696	SOLARUS	Telephone - WI Rapids/Hot Mix	07/30/2019	\$252.85	P
16191697	WATER WORKS & LIGHTING COMM	Utilities - WI Rapids	07/25/2019	\$13.35	P
16191698	WATER WORKS & LIGHTING COMM	Utilities - WI Rapids	07/25/2019	\$1,869.87	P
16191699	WATER WORKS & LIGHTING COMM	Utilities - WI Rapids	07/25/2019	\$11.94	P
16191700	WATER WORKS & LIGHTING COMM	Utilities - Asphalt Plant	07/25/2019	\$5,138.01	P
16191701	WATER WORKS & LIGHTING COMM	Utilities - Brine Plant	07/25/2019	\$1,086.67	P
16191702	WOOD TRUST BANK	Credit Card Invoice	07/21/2019	\$1,809.66	P
16191703	ALLIANT ENERGY/ WP&L	Streetlights - Grand Rapids	07/19/2019	\$1,021.40	P
16191704	AT&T MOBILITY II LLC	Wireless - Engineer	07/16/2019	\$43.55	P
16191705	ACE HARDWARE	Tube Vinyl	07/23/2019	\$1.18	P
16191706	ADAMS COUNTY HIGHWAY DEPT	Paint	07/31/2019	\$28,826.62	P
16191707	ADVANCED DISPOSAL	Garbage Disposal	07/31/2019	\$114.32	P
16191708	AHLBORN EQUIPMENT	7" Blade, Hearing Protection	07/03/2019	\$102.44	P
16191709	AMERICAN FENCE COMPANY	Fencing	07/16/2019	\$11,550.00	P
16191710	AMERICAN FENCE COMPANY	Fencing	07/26/2019	\$150.00	P
16191711	AMERICAN TRUCKING	Hired Trucks	07/31/2019	\$13,396.24	P
16191712	APPLIED INDUSTRIAL TECHNOLOGY	Hose	07/24/2019	\$72.69	P
16191713	APPLIED MAINTENANCE SUPPLIES & SOLUTIONS	Hand Cleaner/Parts	07/03/2019	\$684.62	P
16191714	APPLIED MAINTENANCE SUPPLIES & SOLUTIONS	Battery Cable, Parts	07/25/2019	\$671.09	P
16191715	ARING EQUIPMENT COMPANY	Cab Strap Kit	06/14/2019	\$25.65	P
16191716	ARING EQUIPMENT COMPANY	Shim, Shaft, Mounting Plate	06/26/2019	(\$2,442.19)	P
16191717	ARING EQUIPMENT COMPANY	Sensor	07/17/2019	\$4,393.58	P
16191718	ARING EQUIPMENT COMPANY	Tooth	07/17/2019	\$210.49	P
16191719	ARING EQUIPMENT COMPANY	Hydraulic Valve	07/17/2019	\$109.12	P

Committee Report - County of Wood

Highway Department - July, 2019

16191686 - 16191923

Voucher	Vendor Name	Nature of Claim	Doc Date	Amount	Paid
16191720	ARING EQUIPMENT COMPANY	Switches	07/24/2019	\$149.87	P
16191721	NORTH CENTRAL UTILITY OF WI	Valve/Clamp	07/02/2019	\$85.77	P
16191722	NORTH CENTRAL UTILITY OF WI	6 Oval Backup LED Kit	07/05/2019	\$112.72	P
16191723	NORTH CENTRAL UTILITY OF WI	Sockets, Valve	07/08/2019	\$74.70	P
16191724	NORTH CENTRAL UTILITY OF WI	D-Ring w/Weld Bracket	07/09/2019	\$33.16	P
16191725	NORTH CENTRAL UTILITY OF WI	Wideload Banner, Load Sign	07/09/2019	\$54.17	P
16191726	NORTH CENTRAL UTILITY OF WI	Binkley 51K 10x10 Sand Sh	07/16/2019	\$390.27	P
16191727	NORTH CENTRAL UTILITY OF WI	LED Model 60 Strobe	07/18/2019	\$275.41	P
16191728	NORTH CENTRAL UTILITY OF WI	8" Round	07/18/2019	\$101.76	P
16191729	NORTH CENTRAL UTILITY OF WI	Diaphragm, T-20 Clamp Band Kit	07/22/2019	\$10.73	P
16191730	NORTH CENTRAL UTILITY OF WI	Valve	07/22/2019	\$32.40	P
16191731	NORTH CENTRAL UTILITY OF WI	B/U Alarm	07/26/2019	\$58.10	P
16191732	NORTH CENTRAL UTILITY OF WI	Bee Line Inspection	07/30/2019	\$335.48	P
16191733	NORTH CENTRAL UTILITY OF WI	Truck Valve Extension	07/30/2019	\$14.25	P
16191734	BAUER BUILT INC	Tires	07/22/2019	\$1,658.32	P
16191735	BAUER BUILT INC	Tires	07/22/2019	\$3,200.40	P
16191736	BROOKS TRACTOR COMPANY	Cutting Edge	07/16/2019	\$1,991.00	P
16191737	BROOKS TRACTOR COMPANY	Pedals, Linkage	07/29/2019	\$1,681.83	P
16191738	BROOKS TRACTOR COMPANY	Pinion Shaft, Seal	07/29/2019	\$2,227.82	P
16191739	BROOKS TRACTOR COMPANY	Bearing Cones & Cups	07/29/2019	\$629.37	P
16191740	BURNS INDUSTRIAL SUPPLY CO INC	Couplings, Fittings	07/18/2019	\$132.62	P
16191741	ADVANCE AUTO PARTS	Medium Vis Oil w/UV Dye	07/01/2019	\$24.83	P
16191742	ADVANCE AUTO PARTS	Battery	07/02/2019	\$111.77	P
16191743	ADVANCE AUTO PARTS	Filters, Glass Cleaner	07/02/2019	\$74.85	P
16191744	ADVANCE AUTO PARTS	Battery Core Credit	07/03/2019	(\$22.00)	P
16191745	ADVANCE AUTO PARTS	Core Return	07/03/2019	(\$0.01)	P
16191746	ADVANCE AUTO PARTS	Lube, Fuel Filter Kit	07/03/2019	\$77.70	P
16191747	ADVANCE AUTO PARTS	Lube, Fuel Filter Kit	07/03/2019	\$77.70	P
16191748	ADVANCE AUTO PARTS	Brake Hose	07/08/2019	\$44.51	P
16191749	ADVANCE AUTO PARTS	Brake Mstr Cyl - Core Return	07/09/2019	(\$40.00)	P
16191750	ADVANCE AUTO PARTS	Brake Mstr Cyl	07/09/2019	\$68.27	P
16191751	ADVANCE AUTO PARTS	Brk Cal w/Hdw	07/09/2019	(\$103.53)	P
16191752	ADVANCE AUTO PARTS	Carb Choke Low VOC	07/09/2019	\$6.78	P
16191753	ADVANCE AUTO PARTS	Oil Filters	07/11/2019	\$9.45	P
16191754	ADVANCE AUTO PARTS	Brake Pads, Rotors	07/16/2019	\$261.89	P
16191755	ADVANCE AUTO PARTS	ABS Speed Sensor	07/16/2019	\$88.43	P
16191756	ADVANCE AUTO PARTS	Engine Enamel - Old Ford Blue	07/16/2019	\$6.71	P
16191757	ADVANCE AUTO PARTS	Oil Drain Plug	07/17/2019	(\$6.08)	P
16191758	ADVANCE AUTO PARTS	Filters	07/17/2019	\$79.78	P
16191759	ADVANCE AUTO PARTS	Applicator Gun, 3M Automix	07/17/2019	\$108.21	P
16191760	ADVANCE AUTO PARTS	Oil Drain Plugs	07/17/2019	\$12.16	P
16191761	ADVANCE AUTO PARTS	Emmissions Elbows	07/17/2019	\$5.21	P
16191762	ADVANCE AUTO PARTS	Vacuum Brake Booster	07/17/2019	\$152.09	P
16191763	ADVANCE AUTO PARTS	Oil Filters	07/17/2019	\$11.04	P

Committee Report - County of Wood

Highway Department - July, 2019

16191686 - 16191923

Voucher	Vendor Name	Nature of Claim	Doc Date	Amount	Paid
16191764	ADVANCE AUTO PARTS	Vacuum Brake Booster	07/18/2019	(\$65.00)	P
16191765	ADVANCE AUTO PARTS	Thread Sealant	07/18/2019	\$15.62	P
16191766	ADVANCE AUTO PARTS	Filters, Oil	07/22/2019	\$214.75	P
16191767	ADVANCE AUTO PARTS	Fuel Filter	07/23/2019	(\$78.40)	P
16191768	ADVANCE AUTO PARTS	Battery Cable Lugs	07/23/2019	\$30.18	P
16191769	ADVANCE AUTO PARTS	Filters, Seal Beams	07/23/2019	\$208.41	P
16191770	ADVANCE AUTO PARTS	Rotors, Brake Pads	07/23/2019	\$261.89	P
16191771	ADVANCE AUTO PARTS	Mstr Cut-off Switch	07/23/2019	\$81.99	P
16191772	ADVANCE AUTO PARTS	Lube, Filters	07/24/2019	\$42.20	P
16191773	ADVANCE AUTO PARTS	Rotors, Brake Pads	07/25/2019	\$267.59	P
16191774	ADVANCE AUTO PARTS	Condenser	07/25/2019	\$136.84	P
16191775	ADVANCE AUTO PARTS	Chucks, Filters	07/30/2019	\$29.66	P
16191776	ADVANCE AUTO PARTS	RX Treatment	07/31/2019	\$4.59	P
16191777	CENTRAL CULVERT & SUPPLY LLC	Culverts	07/17/2019	\$6,977.06	P
16191778	CHILI IMPLEMENT CO	Antenna	07/08/2019	\$18.75	P
16191779	COMPLETE CONTROL	Service Call	06/30/2019	\$369.30	P
16191780	CONTECH ENGINEERED SOLUTIONS LLC	Box Culvert	07/25/2019	\$37,500.00	P
16191781	DEAN ALTMANN TRUCKING & EXCAVATING	Hired Trucks/Haul Backhoe	07/31/2019	\$3,863.11	P
16191782	FASTENAL COMPANY	Clevis Slip Hooks	07/09/2019	\$286.32	P
16191783	FASTENAL COMPANY	Sharpcut Regrind Div	07/09/2019	\$18.68	P
16191784	FASTENAL COMPANY	Eyewear, Ear Plugs, Flags	07/16/2019	\$204.14	P
16191785	FASTENAL COMPANY	Coppertop Batteries	07/23/2019	\$34.41	P
16191786	FRONTIER	Telephone - Marshfield	07/28/2019	\$58.93	P
16191787	FRONTIER	Telephone - Marshfield	07/28/2019	(\$37.18)	P
16191788	HALRON LUBRICANTS INC	Grease,Oil	07/31/2019	\$857.26	P
16191789	HALRON LUBRICANTS INC	Oil	07/31/2019	\$848.00	P
16191790	HIGHWAY CONSTRUCTION PRODUCTS LLC	SKT Impact Head	07/22/2019	\$1,913.45	P
16191791	JOHN DEERE FINANCIAL	Technical Manual, Hydraulic	07/25/2019	\$464.91	P
16191792	JX ENTERPRISES INC	Pipe, Clamps	07/16/2019	\$1,095.94	P
16191793	JX ENTERPRISES INC	Spring-Air Peterbilt	07/17/2019	\$249.98	P
16191794	JX ENTERPRISES INC	Link-Clutch, Rod Ends	07/30/2019	\$425.18	P
16191795	JX ENTERPRISES INC	Pipe Exhaust Mbend	07/31/2019	(\$143.99)	P
16191796	KAFKA CONVEYORS & EQUIPMENT INC	CF Wings	07/11/2019	\$1,113.65	P
16191797	LA TRUCKING	Hired Trucks	07/31/2019	\$8,158.99	P
16191798	MARSHFIELD UTILITIES	Electric/Water/Sewer	07/31/2019	\$116.80	P
16191799	MARSHFIELD UTILITIES	Electric/Water/Sewer	07/31/2019	\$147.98	P
16191800	MARSHFIELD UTILITIES	Electric/Water/Sewer	07/31/2019	\$47.62	P
16191801	MID-STATE TRUCK SERVICE INC	Hose, Cool	07/01/2019	\$19.14	P
16191802	MID-STATE TRUCK SERVICE INC	Reman Alternator	07/03/2019	\$1,183.75	P
16191803	MID-STATE TRUCK SERVICE INC	Sensor Kits	07/09/2019	\$473.14	P
16191804	MILESTONE MATERIALS	Base	07/26/2019	\$717.06	P
16191805	DEERE & COMPANY	3451 John Deere Tractor	07/26/2019	\$79,351.99	P
16191806	MILLER-BRADFORD & RISBERG INC	Reman Alternator	07/16/2019	\$421.28	P
16191807	MILLER-BRADFORD & RISBERG INC	Battery	07/25/2019	\$274.00	P

Committee Report - County of Wood

Highway Department - July, 2019

16191686 - 16191923

Voucher	Vendor Name	Nature of Claim	Doc Date	Amount	Paid
16191808	MISSISSIPPI WELDERS SUPPLY CO INC	Rental Cylinders	07/20/2019	\$161.20	P
16191809	MISSISSIPPI WELDERS SUPPLY CO INC	4-1/2 x .045 x 7/8 Grit	07/22/2019	\$75.50	P
16191810	MSC INDUSTRIAL SUPPLY CO	Hip Wader Boots	07/09/2019	\$83.28	P
16191811	PINE RIVER GROUP	Sign Posts	07/09/2019	\$4,064.48	P
16191812	PRECISE MRM LLC	FlatPlan USA&GPRS NAF&Software	07/31/2019	\$648.00	P
16191813	PROVISION PARTNERS	Diesel Fuel & Gasoline	07/31/2019	\$63,870.45	P
16191814	RAPIDS RENTAL & SUPPLY	Chainsaw Chain	07/23/2019	\$93.29	P
16191815	RAPIDS RENTAL & SUPPLY	Restock Fee	07/24/2019	\$40.00	P
16191816	RAPIDS RENTAL & SUPPLY	Chainsaw Chain	07/24/2019	\$166.68	P
16191817	RAPIDS RENTAL & SUPPLY	Fuel Cap	07/25/2019	\$4.05	P
16191818	RENT-A-FLASH INC	ATV Route Signs, Arrows	07/12/2019	\$490.70	P
16191819	ROBERTS IRRIGATION COMPANY INC	Kamlock Alum 3" ML X FPT	07/31/2019	\$21.12	P
16191820	RON'S REFRIGERATION & AC INC	Heaters - Marshfield Shop	02/15/2019	\$8,200.00	P
16191821	SCHILL TRUCKING INC	Hired Trucks	07/31/2019	\$6,913.43	P
16191822	SERWE IMPLEMENT MUNICIPAL SALES CO LLC	Asy, Hub & Spindle-5 Bolt	07/13/2019	\$160.25	P
16191823	SERWE IMPLEMENT MUNICIPAL SALES CO LLC	Roll Pin, Blade	07/13/2019	\$769.49	P
16191824	STAINLESS & REPAIR INC	Insta Chain Cap, Clamp, Diaphr	07/08/2019	\$212.25	P
16191825	STAINLESS & REPAIR INC	Vibrator DC3200	07/15/2019	\$515.03	P
16191826	STAR ENVIRONMENTAL INC.	Wetland Delineation-Mfld Shop	07/30/2019	\$1,750.00	P
16191827	STERNWEIS AND SONS INC	AFA-4000 PSI Mix	07/23/2019	\$280.00	P
16191828	SUPERIOR CHEMICAL CORPORATION	Hand Cleaner	07/10/2019	\$123.86	P
16191829	TEAM MATTHEWS	Tires	07/02/2019	\$740.00	P
16191830	TEAM MATTHEWS	Alignment	07/10/2019	\$69.99	P
16191831	TEAM MATTHEWS	Tires	07/15/2019	\$497.60	P
16191832	TEAM MATTHEWS	Alignment	07/29/2019	\$69.99	P
16191833	TOOL SHED	Filter Socket, Double Flarin	07/01/2019	\$89.90	P
16191834	TOOL SHED	Ratchet, SKT 19MM	07/03/2019	\$15.44	P
16191835	TOOL SHED	Step Drill	07/25/2019	\$34.95	P
16191836	TRACTOR SUPPLY CREDIT PLAN	Small Tools	07/30/2019	\$1,641.94	P
16191837	TRUCK COUNTRY OF WISCONSIN	Pax Frame Hanger	07/23/2019	\$199.14	P
16191838	TRUCK COUNTRY OF WISCONSIN	Terminal, Female, Relay	07/19/2019	\$53.00	P
16191839	TRUCK COUNTRY OF WISCONSIN	Gear-Strg	07/23/2019	\$1,197.89	P
16191840	TRUCK COUNTRY OF WISCONSIN	Hose-Press	07/24/2019	\$59.42	P
16191841	TRUCK COUNTRY OF WISCONSIN	Tube-Fluid, Power Steering	07/26/2019	\$346.71	P
16191842	TRUCK COUNTRY OF WISCONSIN	Switch, Valve Asy, Valves	07/24/2019	\$526.33	P
16191843	TRUCK COUNTRY OF WISCONSIN	Valve Asy	07/25/2019	\$93.69	P
16191844	TRUCK COUNTRY OF WISCONSIN,	Hose-Fluid, Power Steering	07/30/2019	\$84.42	P
16191845	TRUCK COUNTRY OF WISCONSIN	Switch-Rocker	07/31/2019	\$52.86	P
16191846	UNITED RENTALS NORTH AMERICA INC	Throttle Cable	07/02/2019	\$210.63	P
16191847	VAN ERT ELECTRIC COMPANY INC	Hot Mix Plant	07/10/2019	\$502.48	P
16191848	VAN ERT ELECTRIC COMPANY INC	Hot Mix Cable Tray/Power Cable	07/10/2019	\$205.10	P
16191849	VAN ERT ELECTRIC COMPANY INC	Hot Mix Cable Tray/Power Cable	07/18/2019	\$676.57	P
16191850	VERMEER SALES AND SERVICE INC	Tooth-Straight, Capscrew	07/03/2019	\$207.31	P
16191851	V & H AUTOMOTIVE	Element	07/19/2019	\$134.90	P

Highway Department - July, 2019

16191686 - 16191923

Voucher	Vendor Name	Nature of Claim	Doc Date	Amount	Paid
16191852	ISTATE TRUCK CENTER	Tube	07/01/2019	\$6.78	P
16191853	ISTATE TRUCK CENTER	Valve, Clamp	07/02/2019	\$191.63	P
16191854	ISTATE TRUCK CENTER	Sensor, Nitrogen Oxide	07/03/2019	\$543.15	P
16191855	ISTATE TRUCK CENTER	Clamp	07/08/2019	(\$12.75)	P
16191856	ISTATE TRUCK CENTER	Sensor, Nitrogen Oxide	07/08/2019	(\$92.57)	P
16191857	ISTATE TRUCK CENTER	St. Ell	07/08/2019	\$2.33	P
16191858	ISTATE TRUCK CENTER	Universal Joint Kit/Drive Shaf	07/09/2019	\$143.91	P
16191859	ISTATE TRUCK CENTER	Continuous Duty Solenoid	07/17/2019	\$24.09	P
16191860	ISTATE TRUCK CENTER	12V Starting Battery	07/18/2019	\$114.11	P
16191861	ISTATE TRUCK CENTER	38MT Reman Starter	07/18/2019	\$364.42	P
16191862	ISTATE TRUCK CENTER	12V Starting Battery	07/18/2019	\$114.11	P
16191863	ISTATE TRUCK CENTER	Screws	07/19/2019	\$36.36	P
16191864	ISTATE TRUCK CENTER	Harn-HVAC, Motor-Blower	07/22/2019	\$194.34	P
16191865	ISTATE TRUCK CENTER	M Pipe, Hose, Switch, Clamp	07/23/2019	\$21.30	P
16191866	ISTATE TRUCK CENTER	ID/OD 90 Deg 18	07/25/2019	\$44.24	P
16191867	ISTATE TRUCK CENTER	38MT Reman Starter, Switch	07/31/2019	(\$150.14)	P
16191868	WE ENERGIES	Natural Gas - WI Rapids	07/30/2019	\$25.98	P
16191869	WE ENERGIES	Natural Gas - Brine Plant	07/30/2019	\$15.81	P
16191870	WE ENERGIES	Natural Gas - WI Rapids Shop	07/30/2019	\$14.20	P
16191871	WEYERS EQUIPMENT INC	Filters	07/10/2019	\$101.25	P
16191872	WISCONSIN VALLEY BUILDING PRODUCTS	Lok-Bolts	07/19/2019	\$97.50	P
16191873	WISCONSIN VALLEY BUILDING PRODUCTS	Milwaukee Circular Saw	07/31/2019	\$169.95	P
16191874	WISCONSIN METALS	Blacksmith Steel	07/10/2019	\$743.50	P
16191875	WISCONSIN LIFTING SPECIALISTS	Chainslings w/Clevis Slip Hook	07/08/2019	\$842.58	P
16191876	WISCONSIN LIFTING SPECIALISTS	Poly Sling	07/12/2019	\$37.23	P
16191877	WISCONSIN LIFTING SPECIALISTS	Inspect/Replace/Chain Sling	07/30/2019	\$333.53	P
16191878	ZARNOTH BRUSH WORKS INC	Wire Main & Poly Side Brushes	07/15/2019	\$613.35	P
16191879	COMPLETE CONTROL	Pleated Air Filter	07/31/2019	\$86.40	P
16191880	BADGER SCALE	Annual Scale Inspections	07/31/2019	\$350.00	P
16191881	BEAVER OF WISCONSIN INC	Soap, Grease Cutter	07/31/2019	\$351.50	P
16191882	WISCONSIN MEDIA	Legal Notices	07/31/2019	\$25.68	P
16191883	CINTAS CORPORATION	Cleaning Rugs - Hot Mix Plant	07/03/2019	\$26.78	P
16191884	CINTAS CORPORATION	Cleaning Rugs - Hot Mix Plant	07/17/2019	\$26.78	P
16191885	CINTAS CORPORATION	Cleaning Rugs - Hot Mix Plant	07/31/2019	\$26.78	P
16191886	CINTAS CORPORATION	Cleaning Uniforms	07/01/2019	\$241.19	P
16191887	CINTAS CORPORATION	Cleaning Uniforms	07/08/2019	\$249.79	P
16191888	CINTAS CORPORATION	Cleaning Uniforms	07/15/2019	\$237.57	P
16191889	CINTAS CORPORATION	Cleaning Uniforms	07/22/2019	\$245.15	P
16191890	CINTAS CORPORATION	Cleaning Uniforms	07/29/2019	\$236.55	P
16191891	CINTAS CORPORATION	Cleaning Rugs & Uniforms	07/03/2019	\$645.90	P
16191892	CINTAS CORPORATION	Cleaning Rugs & Uniforms	07/10/2019	\$649.02	P
16191893	CINTAS CORPORATION	Cleaning Rugs & Uniforms	07/17/2019	\$624.90	P
16191894	CINTAS CORPORATION	Cleaning Rugs & Uniforms	07/24/2019	\$628.02	P
16191895	CINTAS CORPORATION	Cleaning Rugs & Uniforms	07/31/2019	\$624.90	P

Committee Report - County of Wood

Highway Department - July, 2019

16191686 - 16191923

Voucher	Vendor Name	Nature of Claim	Doc Date	Amount	Paid
16191896	HOME DEPOT CREDIT SERV (Highway)	Shop Supplies	08/05/2019	\$581.82	P
16191897	MILESTONE MATERIALS	Base - CTH S	07/31/2019	\$9,839.47	P
16191898	MILESTONE MATERIALS	Base	07/31/2019	\$3,195.36	P
16191899	STERLING WATER INC	Water for Hot Mix	07/31/2019	\$40.45	P
16191900	TRI-COUNTY PAVING INC	CTH S Pulverizing	07/31/2019	\$17,721.93	P
16191901	WE ENERGIES	Natural Gas - Asphalt Plant	07/31/2019	\$4,064.32	P
16191902	WE ENERGIES	Natural Gas - Marshfield	07/31/2019	\$25.40	P
16191903	WOOD COUNTY REGISTER OF DEEDS	CTH U Recording Fees	07/31/2019	\$300.00	P
16191904	KOLO TRUCKING AND EXCAVATING INC	Hot Mix Sand	08/05/2019	\$4,606.47	P
16191905	MARATHON COUNTY TREASURER	CTH S Water Truck	08/06/2019	\$1,413.27	P
16191906	QUEST CIVIL ENGINEERS LLC	Wetlands Monitoring	08/05/2019	\$333.53	P
16191907	RTVISION	Annual Support/Maintenance	08/01/2019	\$2,811.39	P
16191908	WAUSHARA COUNTY TREASURER	Spraying Vegetation	08/05/2019	\$3,541.76	P
16191909	WI COUNTY HIGHWAY ASSOCIATION	Highway Conference	08/08/2019	\$95.00	P
16191910	WI DEPT OF TRANSPORTATION - BFS	West County Line - Marshfield	08/01/2019	\$28,342.17	P
16191911	WI DEPT OF TRANSPORTATION - BFS	Batterman Road Bridge	08/01/2019	\$220.71	P
16191912	CEI ENTERPRISES INC	9010 HCS-100 Heater	08/14/2019	\$52,402.00	P
16191913	BROOKS TRACTOR COMPANY	Excavator Rental-Culvert Work	07/29/2019	\$9,000.00	P
16191914	FLINT HILLS RESOURCES LP	PG 58-28	06/10/2019	(\$11,556.80)	P
16191915	FLINT HILLS RESOURCES LP	PG 58-28	07/30/2019	\$27,825.50	P
16191916	FLINT HILLS RESOURCES LP	PG 58-28	07/31/2019	\$41,617.05	P
16191917	FLINT HILLS RESOURCES LP	PG 58-28	08/01/2019	\$27,729.55	P
16191918	CNE GAS	Natural Gas - Hot Mix Plant	08/12/2019	\$14,264.25	P
16191919	DEAN ALTMANN TRUCKING & EXCAVATING	Haul Backhoe	08/12/2019	\$240.00	P
16191920	J KISSNER ASPHALT PAVING & MAINTENANCE	Auburndale Walking Trail	08/05/2019	\$6,850.00	P
16191921	OMNNI ASSOCIATES	CTH U Design Engineering	05/13/2019	\$2,350.00	P
16191922	WATER WORKS & LIGHTING COMM	Utilities - Hot Mix Plant	08/13/2019	\$100.77	P
16191923	EARTH INC	CTH N Bridge Pay Request #1	07/12/2019	\$190,475.63	P
Grand Total:				\$1,038,330.88	

Signatures

Committee Chair:

Committee Member:

Committee Member:

Committee Member:

Committee Member:

Committee Member:

Committee Member:

Committee Member:

Committee Member:

Committee Report

County of Wood

Report of claims for: PARKS & FORESTRY DEPT

For the period of: AUGUST (SEPT. HIRC)

For the range of vouchers: 21190809 - 21190959

Voucher	Vendor Name	Nature of Claim	Doc Date	Amount	Paid
21190809	AFTER ALL INC	Septic Pumping for June 2019	07/24/2019	\$1,480.00	P
21190810	AMAZON CAPITAL SERVICES	Office Supplies	07/24/2019	\$36.99	P
21190811	CRESCENT ELECTRIC SUPPLY CO	Electric Items-DP Vault Lights	07/24/2019	\$147.09	P
21190812	FERGUSON ENTERPRISES INC	Supplies-Nepco Bathrooms	07/24/2019	\$92.36	P
21190813	FERGUSON ENTERPRISES INC	Supplies-Nepco Bathrooms	07/24/2019	\$126.79	P
21190814	MENARDS-MARSHFIELD	Toilet & Supplies for NP	07/24/2019	\$236.88	P
21190815	POWER PAC INC	Stihl FS240-2019 Weedie-NP	07/24/2019	\$600.00	P
21190816	QUALITY DOOR & HARDWARE	Louvers, Etc.-White Beach Project	07/24/2019	\$3,425.18	P
21190817	QUALITY DOOR & HARDWARE	Partition-White Beach Shelter	07/24/2019	\$1,029.00	P
21190818	RAPIDS RENTAL & SUPPLY	Supplies for SP	07/24/2019	\$50.43	P
21190819	SHERWIN-WILLIAMS CO THE	Paint & Supplies-SP Pit Toilet	07/24/2019	\$187.72	P
21190820	TOOL SHED	Stumper Supplies-SP	07/24/2019	\$21.95	P
21190821	WISCONSIN VALLEY BUILDING PRODUCTS	Drill Bits for Utility Truck	07/24/2019	\$10.45	P
21190822	POMP'S TIRE SERVICE INC - GREEN BAY	JD Tractor Tires & Labor-DP	07/31/2019	\$576.00	P
21190823	QUALITY DOOR & HARDWARE	Repair Broke Lock-White Beach	07/31/2019	\$191.00	P
21190824	RAPIDS RENTAL & SUPPLY	Chainsaw Chains for Forestry	07/31/2019	\$45.90	P
21190825	STROSSNER CHRISTINE	Partial NP Shelter Refund	07/31/2019	\$200.00	P
21190826	ULTRA-CHEM INC	Cleaning/Operating Supplies	07/31/2019	\$254.72	P
21190827	ULTRA-CHEM INC	Cleaning/Operating Supplies	07/31/2019	\$838.88	P
21190828	WATER WORKS & LIGHTING COMM	Electric Service for SP	07/31/2019	\$54.81	P
21190829	WATER WORKS & LIGHTING COMM	Electric Service for SP	07/31/2019	\$17.12	P
21190830	WATER WORKS & LIGHTING COMM	Electric Service for SP	07/31/2019	\$65.44	P
21190831	WATER WORKS & LIGHTING COMM	Electric Service for SP	07/31/2019	\$303.71	P
21190832	WATER WORKS & LIGHTING COMM	Electric Service for SP	07/31/2019	\$28.39	P
21190833	WATER WORKS & LIGHTING COMM	Electric Service for SP	07/31/2019	\$216.38	P
21190834	WATER WORKS & LIGHTING COMM	Electric Service for SP	07/31/2019	\$69.15	P
21190835	WATER WORKS & LIGHTING COMM	Electric Service for SP	07/31/2019	\$513.35	P
21190836	WATER WORKS & LIGHTING COMM	Electric Service for SP	07/31/2019	\$75.02	P
21190837	WATER WORKS & LIGHTING COMM	Electric Service for SP	07/31/2019	\$440.39	P
21190838	WATER WORKS & LIGHTING COMM	Electric Service for SP	07/31/2019	\$485.99	P
21190839	WOOD TRUST BANK	ATV/Sled Reg, Screens, Etc.	07/31/2019	\$482.37	P
21190840	ACE HARDWARE	Supplies for SP Campground	08/07/2019	\$8.56	P
21190841	ACE HARDWARE	Assorted Supplies for SP	08/07/2019	\$43.81	P
21190842	ACE HARDWARE	Supplies for SP	08/07/2019	\$10.57	P
21190843	CRESCENT ELECTRIC SUPPLY CO	Electric Supplies-White Beach Project	08/07/2019	\$251.30	P
21190844	HAAS BUILDER SUPPLY	Lumber for Forestry Shop	08/07/2019	\$72.10	P
21190845	HAAS BUILDER SUPPLY	Steel, J Channel-White Beach	08/07/2019	\$505.98	P
21190846	HAAS BUILDER SUPPLY	Treated Lumber-NP Bridge Repair	08/07/2019	\$290.16	P
21190847	HILLER'S TRUE VALUE HARDWARE	Glazing Compound-NP	08/07/2019	\$11.98	P

PARKS & FORESTRY DEPT - AUGUST
(SEPT. HIRC)

21190809 - 21190959

21190848	PITTSVILLE FARM & HOME CENTER	Insect Sprays, Etc.-DP	08/07/2019	\$36.96	P
21190849	PITTSVILLE FARM & HOME CENTER	Supplies for DP	08/07/2019	\$37.42	P
21190850	PITTSVILLE FARM & HOME CENTER	Paint for ATV Shelter, Etc.	08/07/2019	\$159.96	P
21190851	PITTSVILLE FARM & HOME CENTER	Grass Seed from DP Storm	08/07/2019	\$14.37	P
21190852	QUALITY DOOR & HARDWARE	Assorted Door Knobs, Dispensers, Etc.	08/07/2019	\$125.00	P
21190853	SHAWN DUPEE CONSTRUCTION LLC	Used Ballast-Shoot Range P Lot	08/07/2019	\$1,368.00	P
21190854	SHERWIN-WILLIAMS CO THE	Paint, Etc.-White Beach Shelter	08/07/2019	\$98.82	P
21190855	ULTRA-CHEM INC	Cleaning/Operating Supplies	08/07/2019	\$973.33	P
21190856	WE ENERGIES	Gas Service for SP	08/07/2019	\$34.84	P
21190857	WISCONSIN VALLEY BUILDING PRODUCTS	Tool Repair for Utility Truck	08/07/2019	\$50.12	P
21190858	ZUELKE NATHAN	Shelter Cancellations for 2020	08/07/2019	\$505.00	P
21190859	ALLIANT ENERGY/ WP&L	Electric Service for PB	08/14/2019	\$111.95	P
21190860	ALLIANT ENERGY/ WP&L	Electric Service for NP	08/14/2019	\$405.78	P
21190861	ALLIANT ENERGY/ WP&L	Electric Service for NP Shower	08/14/2019	\$765.89	P
21190862	ALLIANT ENERGY/ WP&L	Electric Service - NP Shelter	08/14/2019	\$98.28	P
21190863	ALLIANT ENERGY/ WP&L	Electric Service-NP Showers	08/14/2019	\$142.96	P
21190864	ALLIANT ENERGY/ WP&L	Electric Service for NP	08/14/2019	\$328.47	P
21190865	ALLIANT ENERGY/ WP&L	Electric Service for NP	08/14/2019	\$347.21	P
21190866	ALLIANT ENERGY/ WP&L	Electric Service for NP Shop	08/14/2019	\$99.23	P
21190867	ALLIANT ENERGY/ WP&L	Electric Service for NP Cabin	08/14/2019	\$231.78	P
21190868	ALLIANT ENERGY/ WP&L	Electric Service-Nepco Shelter	08/14/2019	\$332.55	P
21190869	ALLIANT ENERGY/ WP&L	Electric Service for ATV Park	08/14/2019	\$36.53	P
21190870	AMAZON CAPITAL SERVICES	Husq. Roller Guide-SP	08/14/2019	\$17.99	P
21190871	BEAVER CREEK NURSERY & LANDSCAPING LLC	Lawn Mowing-July at DP & NP	08/14/2019	\$7,200.00	P
21190872	BUDS CORNER MART	Gas for #598 & Cans-SP	08/14/2019	\$59.67	P
21190873	BUDS CORNER MART	Gas for #11-576-SP	08/14/2019	\$43.49	P
21190874	BUDS CORNER MART	Gas for #561-SP	08/14/2019	\$37.62	P
21190875	BUDS CORNER MART	Gas for #561-SP	08/14/2019	\$66.46	P
21190876	BUDS CORNER MART	Gas for #438-SP	08/14/2019	\$56.64	P
21190877	BUDS CORNER MART	Gas for Gas Cans-SP	08/14/2019	\$13.84	P
21190878	BUDS CORNER MART	Gas for #598-SP	08/14/2019	\$78.01	P
21190879	BUDS CORNER MART	Gas for #533-SP	08/14/2019	\$29.41	P
21190880	BUDS CORNER MART	Gas for #561-SP	08/14/2019	\$54.33	P
21190881	BUDS CORNER MART	Gas for #534-SP	08/14/2019	\$34.99	P
21190882	BUDS CORNER MART	Gas for #592-SP	08/14/2019	\$55.01	P
21190883	BUDS CORNER MART	Gas for #438-SP	08/14/2019	\$64.00	P
21190884	BUDS CORNER MART	Gas for #561-SP	08/14/2019	\$57.66	P
21190885	BUDS CORNER MART	Gas for #533-SP	08/14/2019	\$35.66	P
21190886	BUDS CORNER MART	Gas for #11-576	08/14/2019	\$44.22	P
21190887	BUDS CORNER MART	Gas for #533-SP	08/14/2019	\$37.51	P
21190888	BUDS CORNER MART	Gas for #557-SP	08/14/2019	\$44.55	P
21190889	BUDS CORNER MART	Gas for Cans-SP	08/14/2019	\$14.38	P
21190890	BUDS CORNER MART	Gas for #545-SP	08/14/2019	\$58.36	P
21190891	BUDS CORNER MART	Gas for #561-SP	08/14/2019	\$58.39	P
21190892	BUDS CORNER MART	Gas for #438-SP	08/14/2019	\$46.16	P
21190893	CINTAS CORPORATION	Camp Ranger Uniform Cleaning	08/14/2019	\$237.35	P
21190894	CRESCENT ELECTRIC SUPPLY CO	Utility Box Cover-White Beach	08/14/2019	\$44.69	P
21190895	HOME DEPOT CREDIT SERV (Parks)	White Beach Project Items & Supplies	08/14/2019	\$915.12	P

PARKS & FORESTRY DEPT - AUGUST
(SEPT. HIRC)

21190809 - 21190959

21190896	INSIGHT FS	LP for Nepco Shelter	08/14/2019	\$280.21	P
21190897	INSIGHT FS	LP for PB	08/14/2019	\$333.44	P
21190898	INSIGHT FS	LP for NP Shop	08/14/2019	\$891.22	P
21190899	INSIGHT FS	LP for NP	08/14/2019	\$128.05	P
21190900	INSIGHT FS	LP for NP	08/14/2019	\$112.83	P
21190901	INSIGHT FS	LP for DP Shower	08/14/2019	\$138.96	P
21190902	INSIGHT FS	LP for DP New Showers	08/14/2019	\$116.30	P
21190903	INSIGHT FS	LP for DP	08/14/2019	\$118.58	P
21190904	INSIGHT FS	Diesel for NP	08/14/2019	\$599.79	P
21190905	INSIGHT FS	Gasoline for NP	08/14/2019	\$750.22	P
21190906	INSIGHT FS	Diesel for SP	08/14/2019	\$250.76	P
21190907	INSIGHT FS	Gas for NP	08/14/2019	\$755.14	P
21190908	LAKESIDE OASIS LLC	Gas for #757-Forester	08/14/2019	\$36.11	P
21190909	LAKESIDE OASIS LLC	Gas for Ford Ranger-Forester	08/14/2019	\$44.16	P
21190910	LAKESIDE OASIS LLC	Gas for #610	08/14/2019	\$65.20	P
21190911	LAKESIDE OASIS LLC	Gas for Forester's Truck	08/14/2019	\$42.75	P
21190912	LAKESIDE OASIS LLC	Gas for #563-DP	08/14/2019	\$81.22	P
21190913	LAKESIDE OASIS LLC	Gas for Ford Ranger-Forester	08/14/2019	\$38.72	P
21190914	LAKESIDE OASIS LLC	Gas for #545-DP	08/14/2019	\$75.61	P
21190915	LAKESIDE OASIS LLC	Gas for #569-Forestry Tech	08/14/2019	\$72.15	P
21190916	LAKESIDE OASIS LLC	Gas for #610-DP	08/14/2019	\$65.08	P
21190917	LAKESIDE OASIS LLC	Gas for #583-DP	08/14/2019	\$107.03	P
21190918	LAKESIDE OASIS LLC	Gas for Ford Ranger-Forester	08/14/2019	\$41.19	P
21190919	LAKESIDE OASIS LLC	Gas for Forestry	08/14/2019	\$207.01	P
21190920	LAKESIDE OASIS LLC	Gas for #545-DP	08/14/2019	\$71.78	P
21190921	LAKESIDE OASIS LLC	Gas for #757-Forester	08/14/2019	\$39.73	P
21190922	MENARDS-MARSHFIELD	Water Heater, Etc.-NP	08/14/2019	\$354.98	P
21190923	MENARDS-MARSHFIELD	Assorted Supplies for NP	08/14/2019	\$223.80	P
21190924	MY FLEET CENTER (SUPER LUBE)	Oil Change & Check-Ford Ranger	08/14/2019	\$42.99	P
21190925	OAKDALE ELECTRIC CO	Electric Srv-DP Bath House	08/14/2019	\$32.66	P
21190926	OAKDALE ELECTRIC CO	Electric Service for DP	08/14/2019	\$38.18	P
21190927	OAKDALE ELECTRIC CO	Electric Service for DP Dam	08/14/2019	\$57.84	P
21190928	OAKDALE ELECTRIC CO	Electric Srv-DP Loop 3-Showers	08/14/2019	\$58.19	P
21190929	OAKDALE ELECTRIC CO	Electric Service - DP Shelter	08/14/2019	\$59.79	P
21190930	OAKDALE ELECTRIC CO	Electric Srv-DP Loop 2	08/14/2019	\$733.64	P
21190931	OAKDALE ELECTRIC CO	Electric Srv-DP Lake Road	08/14/2019	\$38.90	P
21190932	OAKDALE ELECTRIC CO	Electric Srv-DP Overflow Area	08/14/2019	\$163.07	P
21190933	OAKDALE ELECTRIC CO	Electric Srv-DP Site 7E Area	08/14/2019	\$679.26	P
21190934	OAKDALE ELECTRIC CO	Electric Service for DP	08/14/2019	\$952.52	P
21190935	OAKDALE ELECTRIC CO	Electric Srv-DP-Office/Loop 1	08/14/2019	\$126.82	P
21190936	OAKDALE ELECTRIC CO	Electric Service-DP Loop 3	08/14/2019	\$560.36	P
21190937	OAKDALE ELECTRIC CO	Electric Service for DP Shop	08/14/2019	\$191.34	P
21190938	POWER PAC INC	Chainsaw Oil-DP	08/14/2019	\$32.32	P
21190939	POWER PAC INC	Woodcutter Oil-NP	08/14/2019	\$46.64	P
21190940	PROVISION PARTNERS	Gas for Cans & #583-DP	08/14/2019	\$123.63	P
21190941	PROVISION PARTNERS	Gas for #01-504-DP	08/14/2019	\$15.76	P
21190942	PROVISION PARTNERS	Gas for Cans-DP	08/14/2019	\$33.65	P
21190943	PROVISION PARTNERS	Gas for Cans-DP	08/14/2019	\$16.76	P

PARKS & FORESTRY DEPT - AUGUST
(SEPT. HIRC)

21190809 - 21190959

21190944	PROVISION PARTNERS	Gas for Cans-DP (CO-29)	08/14/2019	\$16.81	P
21190945	PROVISION PARTNERS	Gas for Cans-DP	08/14/2019	\$15.23	P
21190946	PROVISION PARTNERS	Gas & Diesel for Forestry	08/14/2019	\$242.35	P
21190947	SCHROEDER JULIE	Camping Cancellation	08/14/2019	\$36.00	P
21190948	SINGSTOCK DONNA MARIE	Camping Cancellation	08/14/2019	\$69.00	P
21190949	STATE CHEMICAL MANUFACTURING	Cleaning/Operating Supplies	08/14/2019	\$649.46	P
21190950	ADVANCED DISPOSAL	Garbage Service for Parks	08/21/2019	\$958.00	P
21190951	AFTER ALL INC	Septic Pumping for July 2019	08/21/2019	\$1,870.00	P
21190952	AMAZON CAPITAL SERVICES	Office-Laminator Refills, Etc.	08/21/2019	\$234.95	P
21190953	ARCTIC GLACIER INC	Ice for DP Campground	08/21/2019	\$462.46	P
21190954	ARCTIC GLACIER INC	Ice for NP Campground	08/21/2019	\$490.78	P
21190955	ARCTIC GLACIER INC	Ice for SP Campground	08/21/2019	\$617.15	P
21190956	CENTRAL WI ATV RIDERS INC	Reimbursement-ATV Maintenance	08/21/2019	\$8,299.00	P
21190957	LADICK TRUCKING & EXCAVATING	Black Dirt-SP Storm Damage	08/21/2019	\$417.60	P
21190958	TURF TAMERS LLC	Lawn Cutting-SP/Nepco-7/2&7/10	08/21/2019	\$2,520.00	P
21190959	WISCONSIN COUNTY FOREST ASSOCIATION	Avenza Systems License Fee-Forestry	08/21/2019	\$59.98	P

Grand Total:

\$56,212.99

Signatures

Committee Chair:

Committee Member:

Committee Member:

Committee Member:

Committee Member:

Committee Member:

Committee Member:

Committee Member:

Committee Member:



Cardholder Account Summary					
DENNIS QUINNELL ##### 0583			Payments & Other Credits \$139.71-	Purchases & Other Charges \$550.85	Cash Advances \$0.00
					Total Activity \$411.14
Cardholder Account Detail					
Trans Date	Post Date	Plan Name	Reference Number	Description	Amount
1. - 06/24	06/26	PBUS01	24081629176018018268951	EMERGENCY MEDICAL PRODUC 800-5586270 OH	\$37.26 ✓
2. - 06/26	06/27	PBUS01	24707809177027016620791	GOLF CART KING LLC 877-960-5464 TX	\$42.90 ✓
3. - 06/28	06/30	PBUS01	24492159179637171433595	SP * COLOURTREE INC HTTPSCOLOURTR- CA <i>Screens for wood shed - Sp</i>	\$249.98 ✓
4. - 07/02	07/04	PBUS01	24081629184018018769701	EMERGENCY MEDICAL PRODUC 800-5586270 OH <i>Brackets</i>	\$81.00 ✓
5. - 07/02	07/04	PBUS01	24137469184500940536543	TRACTOR SUPPLY #194 WISC RAPIDS WI	\$19.99 ✓
6. - 07/06	07/07	PBUS01	24692169187100650020885	Amazon Prime Amzn.com/bill WA	\$119.72 ✓
7. - 07/08	07/09		74137469190001223789534	CREDIT VOUCHER	\$19.99 ✓
8. - 07/09	07/10		74692169190100421106674	TRACTOR SUPPLY #194 WISC RAPIDS WI CREDIT VOUCHER Amazon Prime Amzn.com/bill WA	\$119.72- ✓

Cardholder Account Summary					
SANDRA GREEN ##### 4528			Payments & Other Credits \$119.00-	Purchases & Other Charges \$71.23	Cash Advances \$0.00
					Total Activity \$47.77-
Cardholder Account Detail					
Trans Date	Post Date	Plan Name	Reference Number	Description	Amount
1.) - 07/09	07/10		74692169190100417247144	CREDIT VOUCHER Amazon Prime Amzn.com/bill WA	\$119.00- ✓
2.) - 07/19	07/21	PBUS01	24717059201262013052017	DNR EPAY WIN ACS SERV FEE 608-2662621 WI	\$1.05 ✓
3.) - 07/19	07/21	PBUS01	24717059201262013057669	DNR EPAY WIN ACS SERV FEE 608-2662621 WI	\$0.18 ✓
4.) - 07/19	07/21	PBUS01	24717059201262013092849	DNR E PAY WIN ACS 608-2662621 WI	\$60.00 ✓
5.) - 07/19	07/21	PBUS01	24717059201262013097186	DNR E PAY WIN ACS 608-2662621 WI	\$10.00 ✓

- 1.) - Credit for Amazon Prime charge
- 2.) - Service fee - DNR
- 3.) - Service fee - DNR
- 4.) - Registration of ATV & UTV
- 5.) - Registration of snowmobile

1. - Sharps Containers
2. - golf cart fuel pump
3. - Wind screens for wood shed
4. - Brackets for sharps containers
5. - Easy lock
6. - Amazon Prime charge
7. - Returned easy lock
8. - Credited for Amazon Prime charge

County of Wood
DETAILED INCOME STATEMENT W/SUBTOTALS
 Highway Departmentwide
 Saturday, August 31, 2019

	Actual	2019 Budget	Variance	Variance %
REVENUES				
Intergovernmental Revenues				
43531 State Aid-Transportation	\$1,645,818.78	\$2,096,592.00	(\$450,773.22)	(21.50%)
Total Intergovernmental	1,645,818.78	2,096,592.00	(450,773.22)	(21.50%)
Licenses and Permits				
44101 Utility Permits	2,050.02	1,050.00	1,000.02	95.24%
44102 Driveway Permits	1,000.00	860.00	140.00	16.28%
44260 Moving Permits	850.00	1,025.00	(175.00)	(17.07%)
Total Licenses and Permits	3,900.02	2,935.00	965.02	32.88%
Public Charges for Services				
46310 Public Chgs-Frac Sand	248,912.16		248,912.16	0.00%
Total Public Charges for Services	248,912.16		248,912.16	0.00%
Intergovernmental Charges for Services				
47230 State Charges	952,010.00	1,433,100.00	(481,090.00)	(33.57%)
47231 State Charges-Highway	169,638.44	232,838.00	(63,199.56)	(27.14%)
47232 State Charges-Machinery		2,090,226.00	(2,090,226.00)	(100.00%)
47233 State Charges-Performance Based Maintenance	71,780.22		71,780.22	0.00%
47300 Local Gov Chgs	191,571.80	561,660.00	(370,088.20)	(65.89%)
47330 Local Gov Chgs-Transp	404,338.20	1,207,485.00	(803,146.80)	(66.51%)
47332 Local Gov Chgs-Roads		403,360.00	(403,360.00)	(100.00%)
47333 Local Gov Chgs-Bridges	(23,142.30)	27,440.00	(50,582.30)	(184.34%)
Total Charges to Other Governments	1,766,196.36	5,956,109.00	(4,189,912.64)	(70.35%)
Interdepartmental Charges for Services				
47430 Dept Charges-Bldg Rent		34,745.00	(34,745.00)	(100.00%)
47470 Dept Charges-Highway	1,094,591.20	1,783,420.00	(688,828.80)	(38.62%)
Total Interdepartmental Charges	1,094,591.20	1,818,165.00	(723,573.80)	(39.80%)
Total Intergovernmental Charges for Services	2,860,787.56	7,774,274.00	(4,913,486.44)	(63.20%)
Miscellaneous				
48310 Gain/Loss-Sale of Fixed Assets	23,664.87		23,664.87	0.00%
48340 Gain/Loss-Sale of Salvage and Waste	3,613.40	6,700.00	(3,086.60)	(46.07%)
Total Miscellaneous	27,278.27	6,700.00	20,578.27	307.14%
TOTAL REVENUES	4,786,696.79	9,880,501.00	(5,093,804.21)	(51.55%)
EXPENDITURES				
Public Works-Highway				
53110 Hwy-Administration	205,525.49	334,628.00	129,102.51	38.58%
53120 Hwy-Engineer	121,358.68	232,838.00	111,479.32	47.88%
53191 Hwy-Other Administration	203,510.93	323,806.00	120,295.07	37.15%
53210 Hwy-Employee Taxes & Benefits	(539,254.69)		539,254.69	0.00%
53220 Hwy-Field Tools	(9,233.10)	13,400.00	22,633.10	168.90%
53230 Hwy-Shop Operations	207,012.42	331,129.00	124,116.58	37.48%
53232 Hwy-Fuel Handling	(16,451.09)	12,100.00	28,551.09	235.96%
53240 Hwy-Machinery Operations	(883,678.74)	2,173,434.00	3,057,112.74	140.66%
53260 Hwy-Bituminous Ops	94,188.28	230,902.00	136,713.72	59.21%
53262 Hwy-Bituminous Ops	30,576.99	119,372.00	88,795.01	74.39%
53266 Hwy-Bituminous Ops	1,036,484.99	1,762,924.00	726,439.01	41.21%
53270 Hwy-Buildings & Grounds	126,426.91	181,436.00	55,009.09	30.32%
53281 Hwy-Acquisition of Capital Assets	52,402.00		(52,402.00)	0.00%
53310 Hwy-Maintenance CTHS		3,300.00	3,300.00	100.00%
53311 Hwy-Maint CTHS Patrol Sectn	1,287,310.59	1,701,201.00	413,890.41	24.33%
53312 Hwy-Snow Remov	1,044,359.00	919,588.00	(124,771.00)	(13.57%)
53313 Hwy-Maintenance Gang	59,636.51	107,015.00	47,378.49	44.27%
53314 Hwy-Maint Gang-Materials	2,230.49		(2,230.49)	0.00%
53320 Hwy-Maint STHS	1,017,199.73	1,386,445.00	369,245.27	26.63%
53323 Hwy-Maint STHS PBM	45,531.35		(45,531.35)	0.00%
53330 Hwy-Local Roads	461,999.12	1,190,217.00	728,217.88	61.18%
53340 Hwy-County-Aid Road Construction	249,889.25	440,617.00	190,727.75	43.29%
53341 Hwy-County-Aid Bridge Construction	67,360.32	200,422.00	133,061.68	66.39%

8/21/2019

County of Wood
DETAILED INCOME STATEMENT W/SUBTOTALS
 Highway Departmentwide
 Saturday, August 31, 2019

	Actual	2019 Budget	Variance	Variance %
53490 Hwy-State & Local Other Services	181,782.46	555,842.00	374,059.54	67.30%
Total Public Works-Highway	5,046,167.89	12,220,616.00	7,174,448.11	58.71%
Capital Outlay				
57310 Highway Capital Projects	1,511,614.41	2,313,082.00	801,467.59	34.65%
57930 Depreciation & Amortization	5,857.18		(5,857.18)	0.00%
Total Capital Outlay	1,517,471.59	2,313,082.00	795,610.41	34.40%
TOTAL EXPENDITURES	6,563,639.48	14,533,698.00	7,970,058.52	54.84%
NET INCOME (LOSS) *	(1,776,942.69)	(4,653,197.00)	2,876,254.31	(61.81%)



Welcome ATV/UTV ENTHUSIASTS! Join us for a Ribbon Cutting

for the Newly Designated Wood County ATV Trail & Route System

September 18, 2019 @ 5:00 PM • Refreshments Served

Dexter County Park • 8220 State Highway 54 • Pittsville, WI 54446

Follow the Sign

Speakers

DOUG MACHON, COUNTY BOARD CHAIRMAN

ADAM FISCHER, COUNTY BOARD SUPERVISOR,
CHAIRMAN OF THE HIGHWAY, INFRASTRUCTURE &
RECREATION COMMITTEE

KEN CURRY, COUNTY BOARD SUPERVISOR,
CHAIRMAN OF THE CONSERVATION, EDUCATION &
ECONOMIC DEVELOPMENT COMMITTEE

ROB MCCONNEL, VICE PRESIDENT OF MCCONNEL &
ASSOCIATES, SOUTHERN REGIONAL COORDINATOR

MAYOR DALE NICHOLS, PITTSVILLE

Expansion includes new ATV Campsites and 42-miles of on-road routes are opening in Wood County. The new routes will connect existing town road routes and trail systems in adjacent counties, bring visitors and boost the local economy.

Check out the Special Rider incentives offered by Pittsville Businesses!

*Bring your ATV/UTV and try out the new trails/routes!
(Optional & On your own. Ride from 6:00 pm - ?)*

Event Sponsors/Contributors:



Heart of Wisconsin
Chamber of Commerce



**DONAHUE
SUPER SPORTS**



Highway Access Control

Effective 8-01-19

Chapter 1	General Provisions
Chapter 2	Definitions
Chapter 3	Regulations
Chapter 4	Administration and Enforcement

Chapter 1 General Provisions

1.1 Title

This ordinance shall be known as, cited, and referred to as: THE WOOD COUNTY HIGHWAY ACCESS CONTROL ORDINANCE.

1.2 Statutory Authorization.

This ordinance is adopted under the authority of the provisions set forth in Sections 83.015(2), 83.06 and 86.07(2) of the Wisconsin State Statutes.

1.3 Purpose.

The purpose of this ordinance is to restrict and regulate access onto county highways in order to promote the public safety, convenience, general welfare, economic viability, and to protect the public investment of existing and proposed highways by preventing costly road improvements, and to provide for safe and efficient ingress and egress to Wood County Highways.

1.4 Interpretation.

The restrictions, requirements and regulations contained in this ordinance are intended to apply to objects, structures, uses and activities wholly or partially contained in the right-of-way of the Wood County highway system except where specifically indicated. Any object, structure, use or activity partially lying in the right-of-way shall be considered to be entirely within the right-of-way.

1.5 Severability.

If any section, provision, or portion of this ordinance is adjudged invalid by a court of competent jurisdiction, the remainder of this ordinance shall not be affected thereby.

1.6 Compliance with Ordinance.

Any person, firm, or corporation seeking to construct, upgrade or reconstruct a driveway with access upon a county trunk highway within Wood County shall comply with the requirements of this ordinance and any other applicable County ordinances and regulations.

1.7 Effective Date.

The effective date of this ordinance shall be August 1 2019.

Chapter 2 Definitions

The following terms shall be applied as indicated throughout this ordinance.

2.1 **General.**

- (A) The present tense includes the future tense and the singular tense includes the plural.
- (B) The word "shall" is mandatory; the words "may" and "should" are permissive.
- (C) The words "used" or "occupied" also mean intended, designed, or arranged to be used or occupied.
- (D) The word "person" includes any individual, firm, association, joint stock association, organization, partnership, limited, trust, body politic, governmental agency, company, corporation, and includes any trustee, receiver, assignee, or other representative thereof.
- (E) All distances unless otherwise stated shall be measured in feet in the horizontal direction.

2.2 **Definitions.**

ACCESS. Driveway or other ways or means of approach to provide physical entrance or exit to a parcel.

ACCESS PERMIT. A permit from the Wood County Highway Commission granting authority to construct and/or modify and maintain an access onto a CTH.

ADT. Average Daily Traffic generated on a given road or highway.

COMMISSION. Wood County Highway Commissioner and designees.

COMMITTEE. Wood County Highway Infrastructure and Recreation Committee

COUNTY TRUNK HIGHWAY (CTH). Any segment of the Wood County Trunk Highway System pursuant to Section 83.025 of the Wisconsin State Statutes.

DRIVEWAY. Any access to a parcel for motorized or non-motorized vehicles.

LOCAL CTH. Any CTH outside the municipal boundaries of a city or village with a speed limit of 25 mph or less.

PARCEL. The area of land within the property lines of a given piece of property.

ROAD. Any public or private road, street, alley, expressway, highway, avenue, parkway, lane, drive, boulevard, circle, bypass, or other pathways intended for the use of motorized or non-motorized vehicles to obtain access to more than two parcels.

RURAL CTH. Any CTH with a speed limit of 55 m.p.h.

SEMIURBAN CTH. Any CTH with a speed limit of 45 m.p.h.

URBAN CTH. Any CTH with a speed limit below 45 mph and above 25 mph

Chapter 3 Regulations

3.1 **Existing Access.**

Any lawful use of an access to a CTH (via driveway or road) prior to the effective date of this ordinance may be continued.

3.2 Vacated Access.

If the Commission considers the use of an access to have been discontinued for a period of at least one year, the Commission shall notify the owner by certified mail that the access may be considered vacated. The Commission will allow the owner thirty (30) days to reply. If, after this time period and after consideration of the owner's reply, if any, the Commission decides that the access has been discontinued for at least one year, the access may be considered vacated and removed. The Commission will pay the entire cost of removal.

3.3 Change of Use.

An application for a change of use of an existing access is required. The review shall be the same as if it were for a new access. The Commission shall determine if there has been a change in use to an access which will affect safe and efficient ingress and egress to and use of a CTH. This determination shall be based primarily on a significant change in the volume of traffic or the type of vehicle using that access. Upon such determination, the Commission may grant an access permit for the change of use, require modifications to the access to meet standards of this ordinance or deny the request for the change of use unless otherwise provided herein.

3.4 Access to Highway.

Entrance upon or departure from a CTH shall be prohibited except at locations specifically designated by this section. Access permits as stated in sections below shall only be granted upon a field review that confirms that the access provides safe sight distance. No access or road shall be opened into or connected with any CTH without an access permit. No access shall be converted from one use of access to another use of access without an access permit.

3.5 Access Spacing and Frequency.

- (A) In a case where a property owner owns more than one adjacent parcel (of the same land use) with frontage, all parcels shall be treated as a separate parcel for the purposes of this section.
- (B) Where a property owner owns more than one adjacent parcel with frontage on the same side of the CTH, all of which are zoned or used for agriculture, no more than four (4) accesses shall be allowed in a mile.
- (C) Only one access shall be allowed per parcel zoned or used for residential.
- (D) Commercially and industrially zoned parcels may be allowed two accesses provided they each separately meet the remaining criteria of this ordinance.
- (E) Whenever possible, access should be connected to the most minor road adjacent to the property when there is a choice between roads.
- (F) 1. Subject to Paragraph 2 below, access permits for any access shall not be issued if the resulting distance between accesses or between the proposed access and any road intersection shall become less than the following distances measured from the centerline of the proposed access to the centerline of such other access or intersecting road, measured along the CTH:
 - 500' for RURAL CTH
 - 400' for SEMIURBAN CTH
 - 300' for URBAN CTH-I
- 2. The Commission may permit spacing between a field entrance and another access, including, but not limited to, another field entrance, to be closer than the distance required by Paragraph 1 above, but not closer than 250 feet, if the Commission finds that the field entrance location utilizing the reduced spacing requirements would be consistent with public safety considerations.

3. Field entrances not meeting the spacing requirements of Paragraph I above may not be converted to a private entrance without advance review by the Commission and advance written approval of the Commission.
 4. This Subsection (F) does not apply to a LOCAL CTH.
- (G) A new road, in addition to the spacing requirements to adjacent driveway access points in (F) above, must be at least:
- | | |
|--------|-------------------|
| 1,000' | for RURAL CTH |
| 500' | for SEMIURBAN CTH |
| 400' | for URBAN CTH |
| 250' | for LOCAL CTH |

from the nearest adjacent road which enters onto the same side of the CTH in question. Where possible, roads should not be staggered, creating "T" intersections, but connect with another road on the other side of the highway.

3.6 Paved Apron.

Access onto a CTH may require an apron paved with asphalt within the right-of-way of the CTH in instances when usage or drainage warrants as determined by the Commission. This paving shall be at the owner's expense.

3.7 Design Standards.

Driveways and roads within the CTH right-of-way must comply with the following design standards:

- (A) Culverts, when required, must be at least 30 feet long plus end walls, be placed to provide at least 1 foot of cover over the top of the pipe, be a minimum of 18 inches in diameter or equivalent or as large as needed for adequate drainage, be at least 10 feet from the nearest culvert, and be constructed of corrugated metal or dual wall high-density polyethylene HDPE, with metal end walls (plastic end walls shall not be allowed).
- (B) Access height at the point of the culvert, shall be equal to or lower than the level of the outside edge of the adjacent road shoulder.
- (C) Slopes to the side of the access shall not be steeper than 4 to 1 (25 percent) or that of the embankment of the existing CTH, whichever is less. Embankment sloping may be grass, gravel, asphalt, or stone at a maximum size of 8 inches in diameter. Sloping material may not hinder operation of maintenance vehicles.
- (D) Retaining walls, stone walls, etc. shall not be allowed on driveways within the right-of-way.
- (E) Any paving of an access in the right-of-way, whether new, resurface, or replacement shall only be asphalt and only allowed by permit and shall be placed/replaced at the owner's expense.
- (F) Crowning of the access shall be provided with a minimum pitch of 2 percent towards the side of the access.
- (G) Curb and gutter shall not be allowed within the CTH right-of-way for private access.
- (H) The angle formed between the centerline of a driveway (measured along that section of the driveway which is within the highway right-of-way) and the centerline of the CTH shall be as close to 90 degrees as possible, but not less than 75 degrees on either side.
- (I) Facing access on opposite sides of a CTH shall be located directly opposite each other whenever possible.
- (J) Shared access may be required to minimize the number of access points and interruption of traffic flow and provide a safe access point as determined by the Commission.
- (K) Private driveways which provide access to one or two residential parcels shall have a

- maximum 20' width and a 20' return radii. See section (S) Figure 1 below.
- (L) Field entrances shall have a maximum 40' width and 25' return radii. See section (S) Figure 1 below.
 - (M) Commercial driveways shall have a maximum 40' width and 25' return radii. See Section (S) Figure I below.
 - (N) A bypass lane shall be required where the ADT of the adjacent CTH and other factors warrant as determined by the Commission.
 - (O) Turnarounds should be provided so that vehicles do not need to back out onto a CTH and may be required if safety issues warrant installation. Installation shall be at owner's expense. Turnarounds, if constructed, shall be installed on private property.
 - (P) Existing CTH property including road surfaces, curbs, shoulders, slopes, ditches, and vegetation shall be restored to its original condition.
 - (Q) Vision corners must be free of all obstructions at each access point in accordance with the applicable vision corner diagram below. Driveway vision corners are to be measured from a point 3.5 feet above the center of the proposed access, 15 feet back from the edge of pavement of the CTH, to two points 2 feet above the center of the nearest on-coming lane of the CTH in each direction, at a distance of "D" from the point where the CTH meets the center of the proposed access. Distance "D" shall correspond to the speed limit of the road. If the given speed limit is not listed, the next highest speed limit shall be used. See Section (S) Figure 2 below.
 - (R) For any development which will, in the opinion of the Commission, have probable significant impacts on abutting County Trunk Highways due to increased traffic flow, increased turning movements or detrimental effect on existing traffic, the Commission may require a Traffic Impact Analysis (TIA) be completed and submitted to the Commission prior to considering granting an access permit. The TIA shall determine the type of improvements required to provide safe access to the development, including, but not limited to, increased turning radii, segregated turn lanes and bypass lanes. A professional traffic engineer licensed to do work in the State of Wisconsin shall certify the TIA. The costs of the TIA and any required improvements shall be borne by the applicant.
 - (S) [Illustrations on next page]

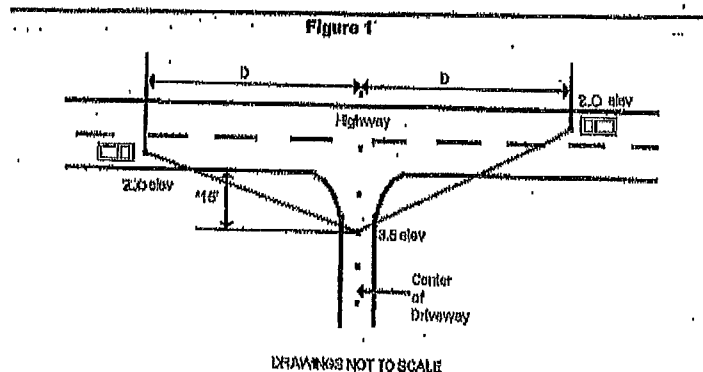
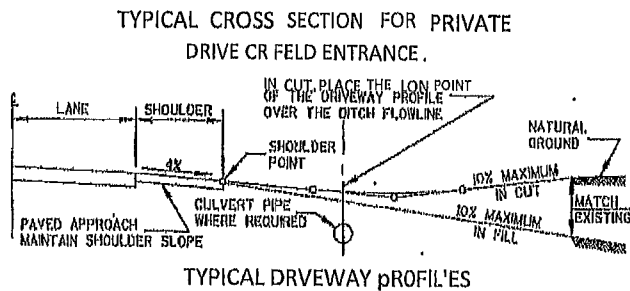
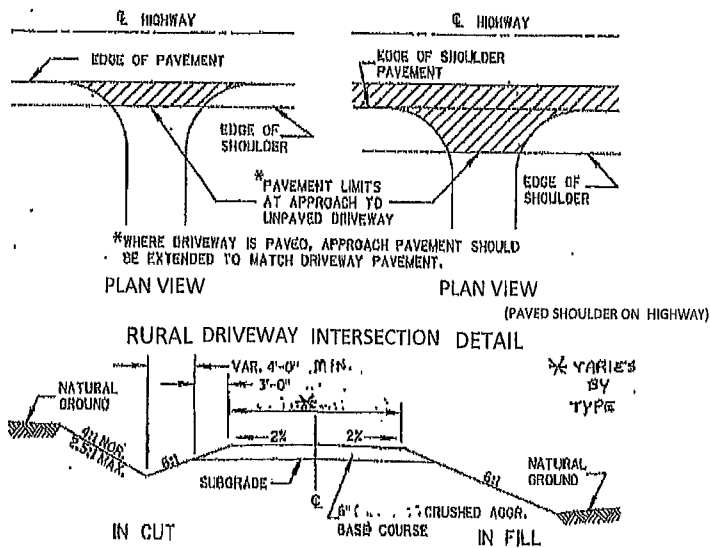

Vision Corner Diagram

Distance D	Posted Speed Limit (MPH)
155	25
250	35
360	45
495	55

FIGURE 2

3.8 Access Control Map.

The location of all access points on CTH's should be established on a map named "THE OFFICIAL HIGHWAY ACCESS CONTROL MAP OF WOOD COUNTY", which will be drawn and updated by the COMMISSION. Copies of this map shall be available to the public at the Wood County Highway Department and Planning & Zoning Department.

Chapter 4 Administration and Enforcement

4.1 Administration.

The Commission is hereby authorized to administer this ordinance outside municipal boundaries within Wood County and within incorporated municipal boundaries for CTHs under the jurisdiction of the Commission. Within incorporated municipal boundaries, the Commission may not be the controlling authority on access to CTHs with a speed limit equal to or less than 35 m.p.h. and therefore must coordinate with the municipality.

Applications for permits shall be made to the Wood County Highway Commission. The Highway Commissioner or designee shall review the proposed development or construction and shall either grant or deny the proposed access permit based upon the provisions, standards, and requirements of this ordinance, within thirty (30) working days of receipt of a complete application.

4.2 Construction.

No structure, object, excavation, or item of landscaping shall be constructed, reconstructed, altered, placed, installed, or planted within the right-of-way of a CTH until an access permit has been issued by the Commission. Any utility relocation required for installation shall be the permittee's responsibility prior to installation.

Said permit shall be placed in clear view as near to the point of proposed construction or access as possible. If not constructed within one year from date of issuance, the access permit shall expire and a new permit shall be applied for. The Commission may extend approval of an access permit at its sole discretion.

4.3 Maintenance.

Wood County shall not be responsible for any routine maintenance of a private access/access culvert including the removal of snow, ice, or sleet from the access or from the culvert. The culvert shall be kept free of debris and sediment. Also, the culvert should be protected from the possibility of fire and rodent damage.

When culverts have failed and create potential for damage to the highway, the property owner will be given notice to replace the culvert. If the condition allows, the property owner will be given 30 days to replace the culvert. If the property owner does not resolve the issue in 30 days, the Commission will perform the necessary work and bill the property owner in accordance with the fee structure.

If the condition requires immediate action by the Commission to prevent damage to the highway, the Commission will take the necessary action to minimize harm and expense to both the highway and the property.

4.4 Fees.

Installation of the access by the Wood County Highway Department shall require all fees to be paid for by the applicant upon billing by the Commission based on the current fee schedule. Payment in full for all fees is required prior to installation. Payment for a required culvert pipe shall be through a Town order. Installation of the access by Private Contractor or Owner shall require the payment of the Access Permit fee and Prepaid Owner Deposit prior to issuance of the Access Permit. Requests for reimbursement of the Prepaid Owner Deposit shall occur within one year of date of issuance of the Access Permit, unless an extension of the Access Permit is requested and approved by the Commission. If no written request for reimbursement of the Prepaid Owner Deposit is received by the Commission within either one year of the date of issuance of the Access Permit, or within one year of the date of approval of an extension of the Access Permit, the Prepaid Owner Deposit shall be retained permanently by the Commission.

4.5 Appeals.

Any person aggrieved by any decision made in the administration of this ordinance may appeal to the Wood County Highway Committee.

Appeals shall be filed within thirty (30) calendar days following the administrative decision by the Commission. Appeals shall be filed in writing with the Committee. The appeal shall specify the legal description of the parcel and access location in question and the reason given for the appeal. If possibly materially affected by the granting of a variance, the adjacent property owner(s) shall be notified by mail of the date and time of the hearing and the appellant's name and the variance requested a minimum of seven (7) calendar days prior to the hearing.

Where the Committee finds that unnecessary hardship may result from strict compliance with these regulations, it may vary the regulations, provided that the public interest is secured and that such variation will not establish an undesirable precedent and will not have the effect of nullifying the intent and purpose of these regulations. Any modifications or variance thus granted shall be entered in the minutes of the Committee setting forth the reasons which, in the judgment of the Committee, justified the modification or variance.

The Committee shall make a decision on the appeal within forty-five (45) calendar days from the day the appeal was filed. The appeal fee shall be as stated in the fee schedule and shall be due and payable at the time of filing of the appeal.

4.6 Violations.

In the case of any violation of this ordinance, the Commission may institute appropriate legal action up to and including removal of any item contrary to this ordinance and revocation of the access permit. Each day in which a violation continues to exist shall constitute a separate offense.

4.7 Penalties.

Any person, firm, or corporation found guilty of violating any part(s) of this ordinance shall be subject to the fees and penalties as listed in the fee schedule and Section 86.07(2) of the Wisconsin State Statutes.

Highway Access Control Ordinance Fee Schedule

Access Installed by Wood County Highway Department

<input type="checkbox"/> Commercial/Industrial Access	Actual Cost
<input type="checkbox"/> Private Residential and Field Driveway Access	\$2000 plus actual cost of pipe
<input type="checkbox"/> Remove Existing Driveway Access	Actual Cost
<input type="checkbox"/> Relocate Existing Driveway Access	\$3000 plus actual cost of pipe, if required
<input type="checkbox"/> Replace Existing Culvert	\$1500 plus actual cost of pipe
<input type="checkbox"/> Install/Replace Apron End Wall	\$500 plus actual cost of end wall(s)
<input type="checkbox"/> Extend Existing Driveway Access	\$1000 plus actual cost of pipe if required
<input type="checkbox"/> Temporary Driveway Access	Actual Cost
<input type="checkbox"/> Enclose Ditch In Right-of-Way	Actual Cost
<input type="checkbox"/> Cattle Crossing	Actual Cost

Access Installed by Private Contractor/Owner

<input type="checkbox"/> Commercial/Industrial Access	\$50 fee plus \$300 deposit
<input type="checkbox"/> Private Residential and Field Driveway Access	\$50 fee plus \$300 deposit
<input type="checkbox"/> Remove Existing Driveway Access	\$50 fee plus \$300 deposit
<input type="checkbox"/> Relocate Existing Driveway Access	\$50 fee plus \$300 deposit
<input type="checkbox"/> Replace Existing Culvert	\$50 fee plus \$300 deposit
<input type="checkbox"/> Install/Replace Apron End Wall	\$50 fee plus \$300 deposit
<input type="checkbox"/> Extend Existing Driveway Access	\$50 fee plus \$300 deposit
<input type="checkbox"/> Temporary Driveway Access	\$50 fee plus \$300 deposit
<input type="checkbox"/> Enclose Ditch In Right-of-Way	\$50 fee plus \$300 deposit
<input type="checkbox"/> Public Road Intersection-Subdivision	\$100 fee plus \$300 deposit
<input type="checkbox"/> Discharge Drain Tile In Ditch of CTH	\$100 fee plus \$300 deposit

Permit Only

<input type="checkbox"/> Change Use of Existing Access Driveway	\$50
<input type="checkbox"/> Pave Existing Driveway Access	\$50

Non-compliance

<input type="checkbox"/> Install Access without Permit	\$500 penalty
<input type="checkbox"/> Paving In the Right-of-Way without Permit	\$200 penalty
<input type="checkbox"/> Removal of Illegally Placed Driveway by Wood County	Actual cost Plus \$200 penalty
<input type="checkbox"/> Failure to maintain a culvert that requires County crews to flush, thaw, or replace in order to maintain the integrity of the roadway.	Actual cost Plus \$500 penalty
<input type="checkbox"/> Appeals (non-refundable)	\$100

\$50 Fee Includes one post-Installation Inspection. \$100 Fee Includes one construction and one post-construction Inspection. \$300 deposit will be returned to owner upon acceptance of completed work. The following exceptions will apply:

- \$50 will be deducted from the deposit for each re-inspection if installation is unacceptable. The remainder will be returned to owner.
- If installation is unacceptable and Wood County has to correct the faulty installation, the deposit will be forfeited by the owner and actual costs for corrections shall be borne by the applicant.
- \$50 will be deducted for one six-month permit extension.

Make checks payable to Wood County Highway Commission and mail to:
Wood County Highway Department
555 17th Avenue North
Wisconsin Rapids, WI 54495



State of Wisconsin
2019 - 2020 LEGISLATURE

LRB-2568/1
EVM:cdc

2019 ASSEMBLY BILL 262

June 7, 2019 - Introduced by Representatives PLUMER, DOYLE, KRUG, KULP, MURSAU, QUINN, SPIROS, SKOWRONSKI, STUCK, JAMES, VRUWINK, DUCHOW, TUSLER, SHANKLAND, EDMING, BRANDTJEN, OTT and VANDERMEER, cosponsored by Senators TESTIN, RINGHAND, FEYEN, OLSEN, MARKLEIN, CARPENTER, BERNIER and COWLES. Referred to Committee on Criminal Justice and Public Safety.

- 1 **AN ACT** *to amend* 346.01 (2); and *to create* 38.04 (4) (e) 8., 115.28 (11) (h), 343.71
2 (5) (h), 346.275 and 346.30 (6) of the statutes; **relating to:** liability of owners
3 of vehicles involved in certain speed limit and failure to yield right-of-way
4 violations, driver education instruction, and providing a penalty.

Analysis by the Legislative Reference Bureau

This bill authorizes the citation of owners of vehicles for certain highway work zone speed and failure to yield violations. The bill also requires driver education instruction related to highway work zone safety.

Current law imposes, with exceptions, liability on the owner of a vehicle that is observed violating certain traffic laws, including illegally passing a school bus or fire truck, illegally crossing a railroad crossing or controlled school crossing, and failing to yield the right-of-way to an emergency vehicle or a funeral procession.

This bill imposes liability on the owner of a vehicle involved in a violation related to the failure to yield the right-of-way to certain persons engaged in maintenance or construction work in a highway work zone. Under this bill, a flagman who observes a vehicle involved in this sort of a failure to yield violation may report the violation to a traffic officer so that a citation may be issued.

An owner is subject to the same forfeiture that would be applicable to the vehicle operator for the violation, but the owner's operating privilege may not be suspended or revoked, and no demerit points may be recorded against the owner's driving record. Among the defenses available to an owner, the owner is not liable if the owner identifies the operator of the vehicle at the time of the violation and the

ASSEMBLY BILL 262

operator admits to being the operator or if the owner has reported the vehicle as stolen. If an owner successfully asserts certain defenses, the person operating the vehicle at the time of the violation may be charged with the violation.

Under current law, the Department of Public Instruction must approve certain driver education courses offered by school districts and establish minimum standards for driver education courses offered by private driver schools, the Technical College System Board must approve courses of study for each program offered in technical college district schools, including driver education courses, and the Department of Transportation licenses private driver schools and DOT may not license a driver school unless its course of instruction includes the content required for TCSB approval of a driver education course.

Under this bill, all approved driver education courses must acquaint each student with the hazards posed by highway work zones and provide at least 30 minutes of instruction in safely dealing with these hazards.

For further information see the *state and local* fiscal estimate, which will be printed as an appendix to this bill.

The people of the state of Wisconsin, represented in senate and assembly, do enact as follows:

1 **SECTION 1.** 38.04 (4) (e) 8. of the statutes is created to read:

2 38.04 (4) (e) 8. Acquaints each student with the hazards posed by highway work
3 zones and provides at least 30 minutes of instruction in safely dealing with these
4 hazards.

5 **SECTION 2.** 115.28 (11) (h) of the statutes is created to read:

6 115.28 (11) (h) Acquaint each student with the hazards posed by highway work
7 zones and provide at least 30 minutes of instruction in safely dealing with these
8 hazards.

9 **SECTION 3.** 343.71 (5) (h) of the statutes is created to read:

10 343.71 (5) (h) Acquaints each student with the hazards posed by highway work
11 zones and provides at least 30 minutes of instruction in safely dealing with these
12 hazards.

13 **SECTION 4.** 346.01 (2) of the statutes is amended to read:

ASSEMBLY BILL 262**SECTION 4**

1 346.01 (2) In this chapter, notwithstanding s. 340.01 (42), “owner” means, with
2 respect to a vehicle that is registered, or is required to be registered, by a lessee of
3 the vehicle under ch. 341, the lessee of the vehicle for purposes of vehicle owner
4 liability under ss. 346.175, 346.195, 346.205, 346.275, 346.452, 346.457, 346.465,
5 346.485, 346.505 (3), 346.675, and 346.945.

6 **SECTION 5.** 346.275 of the statutes is created to read:

7 **346.275 Owner’s liability for vehicle failing to yield right-of-way to**
8 **persons in a work zone.** (1) Subject to sub. (5) (b), the owner of a vehicle involved
9 in a violation of s. 346.27 is liable for the violation as provided in this section.

10 (2) A flagman who observes a violation of s. 346.27 may prepare a written
11 report indicating that a violation has occurred. If possible, the report shall contain
12 the following information:

13 (a) The time and the approximate location at which the violation occurred.

14 (b) The license number and color of the vehicle involved in the violation.

15 (c) Identification of the vehicle as an automobile, motor truck, motor bus,
16 motorcycle, or other type of vehicle.

17 (3) If within 24 hours after observing the violation, the flagman delivers a
18 report under sub. (2) to a traffic officer of the county or municipality in which the
19 violation occurred, the officer may issue a citation under sub. (4). A report that does
20 not contain all the information in sub. (2) shall be maintained by the county or
21 municipality for statistical purposes.

22 (4) (a) Within 48 hours after receiving a report under sub. (3) containing all the
23 information in sub. (2), the traffic officer may issue a citation for a violation of this
24 section to the owner of the vehicle involved in the violation. A citation for a violation

ASSEMBLY BILL 262**SECTION 5**

1 of this section shall be prepared on a uniform traffic citation form under s. 345.11 and
2 personally served on the owner of the vehicle.

3 (b) If with reasonable diligence the owner cannot be served under par. (a),
4 service may be made by leaving a copy of the citation at the owner's usual place of
5 abode within this state in the presence of a competent member of the family at least
6 14 years of age, who shall be informed of the contents thereof.

7 (c) If with reasonable diligence the owner cannot be served under par. (a) or (b)
8 or if the owner lives outside of the jurisdiction of the issuing authority, service may
9 be made by certified mail addressed to the owner's last-known address.

10 **(5)** (a) Except as provided in par. (b), it is not a defense to a violation of this
11 section that the owner was not operating the vehicle at the time of the violation.

12 (b) The following are defenses to a violation of this section:

13 1. That a report that the vehicle was stolen was made by the owner to a law
14 enforcement agency before the violation occurred or within a reasonable time after
15 the violation occurred.

16 2. That the owner of the vehicle provided a traffic officer with the name and
17 address of the person operating the vehicle at the time of the violation and the person
18 so named admits operating the vehicle at the time of the violation. In that case, the
19 person operating the vehicle may be charged under s. 346.27.

20 3. That the vehicle is owned by a lessor of vehicles and is registered in the name
21 of the lessor, that at the time of the violation the vehicle was in the possession of a
22 lessee, and that the lessor provided a traffic officer with the information required
23 under s. 343.46 (3). In that case, the lessee may be charged under s. 346.27.

24 4. That the vehicle is owned by a dealer, as defined in s. 340.01 (11) (intro.), but
25 including the persons specified in s. 340.01 (11) (a) to (d), that at the time of the

ASSEMBLY BILL 262**SECTION 5**

1 violation the vehicle was being operated by a person on a trial run, and that the
2 dealer provided a traffic officer with the name, address, and operator's license
3 number of the person operating the vehicle. In that case, the person operating the
4 vehicle may be charged under s. 346.27.

5 **SECTION 6.** 346.30 (6) of the statutes is created to read:

6 346.30 (6) A vehicle owner found liable under s. 346.275 may be required to
7 forfeit not less than \$60 nor more than \$600. Imposition of liability under s. 346.275
8 shall not result in suspension or revocation of a person's operating privilege under
9 s. 343.30, nor shall it result in demerit points being recorded on a person's driving
10 record under s. 343.32 (2) (a).

11 **SECTION 7. Initial applicability.**

12 (1) The treatment of ss. 38.04 (4) (e) 8., 115.28 (11) (h), and 343.71 (5) (h) first
13 applies to driver education courses that begin on the effective date of this subsection.

14 (END)

From: Chris McDaniel [supervisor2@townshipofrichfield.com]

Sent: July 18, 2019 at 3:00:37 PM

To: Dave LaFontaine, superrn_2@charter.net, kfeirer@frontier.com, Jason Zaleski, Adam Fischer, bretown@frontier.com, Robert Ashbeck, Jake Hahn, William Winch, Mark Holbrook, Kenneth Curry, Douglas Machon, Marion Hokamp, Dennis Polach, William Clendenning, lance1@charter.net, Joseph Zurfluh, Brad Hamilton, Bill Leichtnam

CC: Jim Good, Tirzah Draeger, Tammi Pernsteiner, jimjan.patrick@gmail.com

Subject: County Land & Parks

Members of the Wood County Board of Supervisors,

Recently an email has been circulating among local municipalities requesting a show of support to change in county forest land and how revenue generated from the timber sales is dispersed. In lieu of taxes, the local municipality's receive 10 percent of the annual revenue generated from timber sales in the county. In most cases, the county forest land would generate far more revenue if it were included in the tax role. The 10 percent annual revenue typically does not cover the discrepancy in land value to local municipalities. In addition, in most cases, local municipalities are responsible for maintaining the roadways that allow access to this land for both harvesting and recreational use.

The argument may be made that the townships are benefiting from having county land and parks in their municipality for recreational use. In our circumstance, the township of Richfield has several county parks within the boundary of our municipality. The residents for the Township of Richfield are burdened with the responsibility of maintaining the roadways leading to these county parks. Looking specifically at the North Wood County Park, most people visiting and camping at the North Wood County Park do not reside in the Township of Richfield. The residents of the Township of Richfield are burdened with maintaining two of the three access points to the North Wood County Park. One of these entrances is open when the main gates to the park are open. The other is used as an emergency entrance and exit when there is high water preventing vehicles from utilizing the bridge into the campground area. In the past, the Township of Richfield was approached by the Wood County Highway Department to share repair costs to these access points when the repair work was clearly not on a Township of Richfield Roadway (specifically the south entrance to the North Wood County Park).

It is my understanding that there is not much support for a change in timber sales revenue disbursements. If the Wood County Board decides not to increase the towns share of the revenue generated from timber sales, would it be possible for the county to enter into an agreement with the local municipalities to share the costs of maintaining the roadways that provide direct access to Wood County Land or Parks?--

Thank you,
Chris McDaniel
Township of Richfield, Wood County
Supervisor #2
8620 Richfield Dr.
Marshfield, WI 54449
715-676-2609
supervisor2@townshipofrichfield.com



Red Sands Beach Solar 2 (STONE ENCLOSED SHELTER)

	Roof Mount	Ground Mount
PV System Size	4.5 kW (15 modules)	4.2 kW (14 modules)
Estimated Annual Energy Production	4,892 kWh – 109% offset	5,173 kWh – 112% offset
Levelized Cost of Energy (30 year)	\$.08	\$.11
System Cost	\$13,650 - \$1,638 Focus Rebate = <i>\$12,000 net cost</i>	\$18,100 - \$2,172 Focus Rebate = <i>\$15,928 net cost</i>
30 year IRR	4.2%	1.75%
Simple Payback	Approx 18 years	Approx 19 years

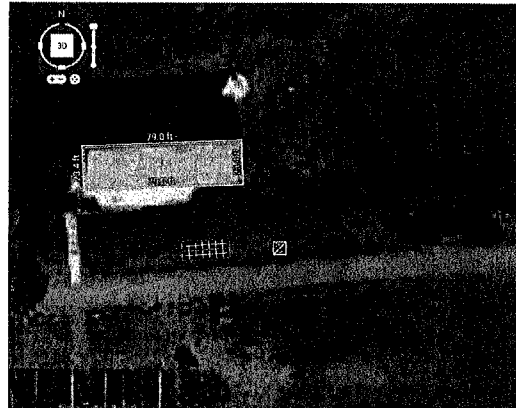

Red Sands Beach Solar (RED SANDS BEACH PAVILION)

	Roof Mount	Ground Mount
PV System Size	4.2 kW (14 modules)	4.2 kW (14 modules)
Estimated Annual Energy Production	5,209 kWh – 112% offset	5,173 kWh – 112% offset
Levelized Cost of Energy (30 year)	\$.074	\$.11
System Cost	\$12,900 - \$1548 Focus Rebate = \$10,712 net cost	\$18,100 - \$2,172 Focus Rebate = \$15,928 net cost
30 year IRR	5.32%	1.75%
Simple Payback	Approx 15 years	Approx 19 years

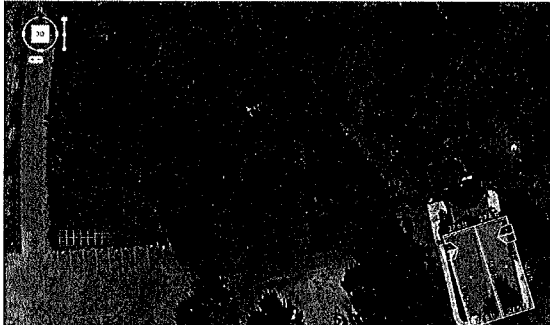

Nepco Park Solar

	Seasonally Adjustable Ground Mount	Ground Mount
PV System Size	8.5 kW (28 modules)	8.5 kW (28 modules)
Estimated Annual Energy Production	11,896 kWh –47 % offset	11,300 kWh – 45% offset
Levelized Cost of Energy (30 year)	\$.089/kWh	\$.068/kWh
System Cost	\$37,000 - \$4,000 Focus Rebate - \$1,281 CWGB Rebate - = \$31,719 <i>net cost</i>	\$24,300 - \$2,916 Focus Rebate – \$1,281 CWGB Rebate = \$20,103 <i>net cost</i>
30 year IRR	5.40%	7.87%
Simple Payback	Approx 18 years	Approx 14 years

Wood County Forest Timber Sale Map



Sale Name: Nature's Touch
Tract 7-19 27 Acres
Sec.5 T22N R04E

Sale Number 778

Contractor Futurewood

Sale area
27 Acres

Hemlock Road

Lone Tree Lane

Legend

-  Blue Paint Line/Property Boundary
-  Red Paint Line/Sale Boundary
-  WCF Property Boundary
-  Access Roads
-  Wood Roads

Scale 8in = 1 Mile

Brockman Road

WOOD COUNTY FOREST

Page 1 of 2

SALE NAME: Nature's Touch

TRACT NUMBER: 7-19

SALE LOCATION

Wood County, Township of: Seneca

Section:5 Town:22N Range: 04E

Sale Size: 27Acres

SALE NUMBER 778

CONTRACTOR Futurewood

CONTRACT PERIOD: Ends 12/31/2019

PRODUCT LISTING:

Est. Volume

Species	Tons 5" top	Notes
Aspen	1390	
Oak	30	
Mixed Hdwd.	230	Mostly Red Maple
Totals	1650	

Contract Amount: \$19,650.20

SALE OBJECTIVES: Main objective of this harvest is to salvage damaged timber within the sale area. Several acres of the stand were blown down completely and the remaining portions of the sale had scattered damage throughout. This sale will work to clean up this damage and regenerate the sale area for future timber management and wildlife benefits.

CUTTING AREA DESCRIPTION: Cutting area consists of 27 acres in 1 cutting unit bound by red and blue paint lines and a town road on the southern boundary. The sale area consists of mature Aspen and Red Maple that has been wind damaged. Damage is in scattered patches throughout the stand. The entire stand will be harvested as part of this sale to promote the best possible regeneration.

CUTTING REQUIREMENTS/SPECIFICATIONS:

- Cut All Aspen and Mixed Hardwood down to 2 inch DBH or any storm damaged Oak.
- Do Not Cut any White or Red Pine, standing Oak that is not damaged, or any red or blue marked trees.
- The standard utilization is 5" minimum top diameter for aspen, oak, and mixed hardwood pulpwood.
- All species and products must be cut concurrently when harvesting the timber.

ACCESS: There is good access to the sale areas either directly off town roads or down existing access roads. Existing access roads are shown on the attached timber sale map.

RESTRICTIONS:

- The county may restrict the type of equipment used on the job if conditions or damage warrant.
- Seasonal Restrictions: Logging chance is dependent on ground and weather conditions. Soils will require dry conditions for harvest.

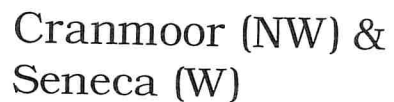

Township 22N - Range 4E

Copyright © 2016 Mapping Solutions

SEE HANSEN PAGE 34

